

STATE OF OREGON

COUNTY OF

HARNEY

CERTIFICATE OF WATER RIGHT

This Is to Certify, That PATRICIA HAYES

of Box 5273, Boise, State of Idaho, 83075, has made proof to the satisfaction of the Water Resources Director, of a right to the use of the waters of a well

a tributary of Soldier Creek for the purpose of irrigation of 139.0 acres

under Permit No. G-4923 and that said right to the use of said waters has been perfected in accordance with the laws of Oregon; that the priority of the right hereby confirmed dates from March 1, 1971

that the amount of water to which such right is entitled and hereby confirmed, for the purposes aforesaid, is limited to an amount actually beneficially used for said purposes, and shall not exceed 1.74 cubic feet per second

or its equivalent in case of rotation, measured at the point of diversion from the stream. The point of diversion is located in the NW 1/4 NW 1/4, Section 13, T. 23 S., R. 32 E., W. M., 190 feet South and 90 feet East from the NW Corner of Section 13.

The amount of water used for irrigation, together with the amount secured under any other right existing for the same lands, shall be limited to one-eightieth of one cubic foot per second per acre, or its equivalent for each acre irrigated and shall be further limited to a diversion of not to exceed 3 acre feet per acre for each acre irrigated during the irrigation season of each year,

and shall conform to such reasonable rotation system as may be ordered by the proper state officer.

A description of the place of use under the right hereby confirmed, and to which such right is appurtenant, is as follows:

- 1.2 acres NW 1/4 NE 1/4
  - 1.6 acres SW 1/4 NE 1/4
  - 32.8 acres NE 1/4 NW 1/4
  - 31.2 acres NW 1/4 NW 1/4
  - 33.6 acres SW 1/4 NW 1/4
  - 35.6 acres SE 1/4 NW 1/4
  - 1.6 acres NE 1/4 SW 1/4
  - 1.4 acres NW 1/4 SW 1/4
- Section 13  
T. 23 S., R. 32 E., W. M.

The right to the use of the water for the purposes aforesaid is restricted to the lands or place of use herein described, and is subject to the existing minimum flow policies established by the Water Policy Review Board.

WITNESS the signature of the Water Resources Director, affixed

this date. April 15, 1977

James E. Sexson  
Water Resources Director

# T.23S. R.32E. W.M.

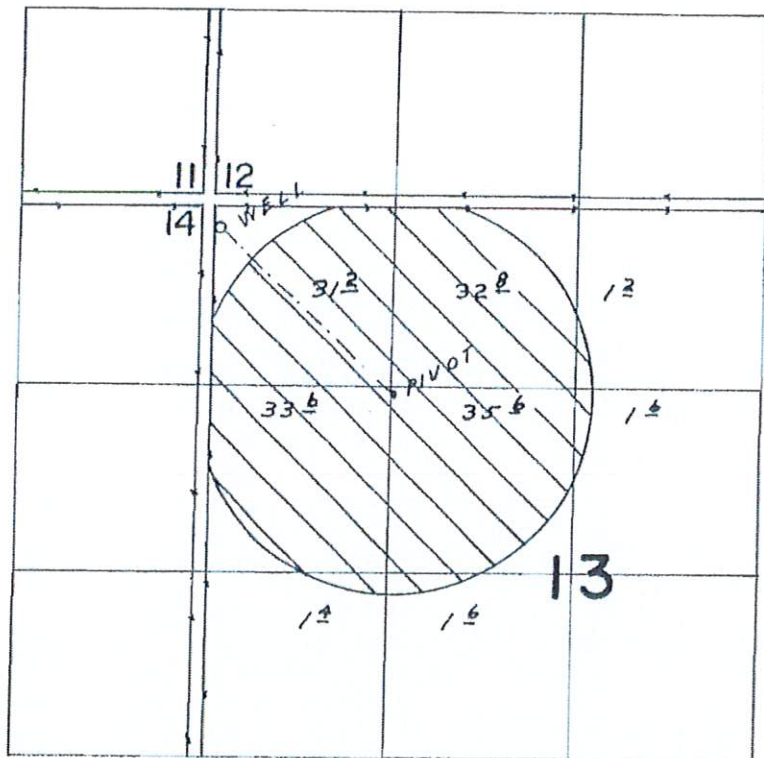

WELL LOC. 190° S. & 90' E FROM NW COR SEC 13

## FINAL PROOF SURVEY UNDER

Application G-5439 Permit No. G-4923  
IN NAME OF

PATRICIA HAYES

Surveyed JUL. 23. 1975, by L.H. NUNN

STATE OF OREGON

COUNTY OF HARNEY

CERTIFICATE OF WATER RIGHT

THIS CERTIFICATE ISSUED TO

ORAMARTIC, INC.  
PO BOX 430  
VALE, OR 97918

confirms the right to use the waters of a WELL in the SILVIES RIVER BASIN for IRRIGATION of 130.4 ACRES.

This right was perfected under Permit G-8311. The date of priority is AUGUST 7, 1978. The amount of water to which this right is entitled is limited to an amount actually used beneficially, and shall not exceed 1.634 CUBIC FEET PER SECOND (cfs) or its equivalent in case of rotation, measured at the well.

The well is located as follows:

Twp	Rng	Mer	Sec	Q-Q	Measured Distances
23 S	32 E	WM	14	NE NE	1190 FEET SOUTH AND 1220 FEET WEST FROM THE NE CORNER OF SECTION 14

The amount of water used for irrigation, together with the amount secured under any other right existing for the same lands, is limited to a diversion of ONE-EIGHTIETH of one cubic foot per second, or its equivalent for each acre irrigated, and shall be further limited to a diversion of not to exceed 3.0 acre-feet per acre for each acre irrigated during the irrigation season of each year. The use shall conform to such reasonable rotation system as may be ordered by the proper state officer.

A description of the place of use to which this right is appurtenant is as follows:

IRRIGATION					
Twp	Rng	Mer	Sec	Q-Q	Acres
23 S	32 E	WM	14	NE NE	32.0
23 S	32 E	WM	14	NW NE	34.0
23 S	32 E	WM	14	SW NE	32.4
23 S	32 E	WM	14	SE NE	32.0
Total:					130.4

This certificate describes that portion of the water right confirmed by Certificate 63579, State Record of Water Right Certificates, NOT modified by the provisions of an order of the Water Resources Director entered **NOV 26 2014**, at Special Order Volume 93, Pages 858-859.

The issuance of this superseding certificate does not confirm the status of the water right in regard to the provisions of ORS 540.610 pertaining to forfeiture or abandonment.

The right to the use of the water for the above purpose is restricted to beneficial use on the lands or place of use described.

WITNESS the signature of the Water Resources Director, affixed NOVEMBER 26 2014.

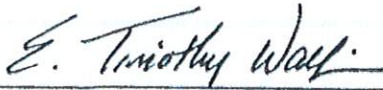

E. Timothy Wallin, Water Right Program Manager for  
THOMAS M. BYLER, DIRECTOR

T. 23S., R. 32E., W.M.

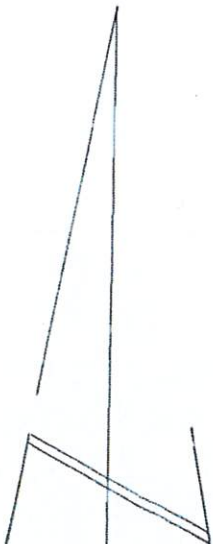
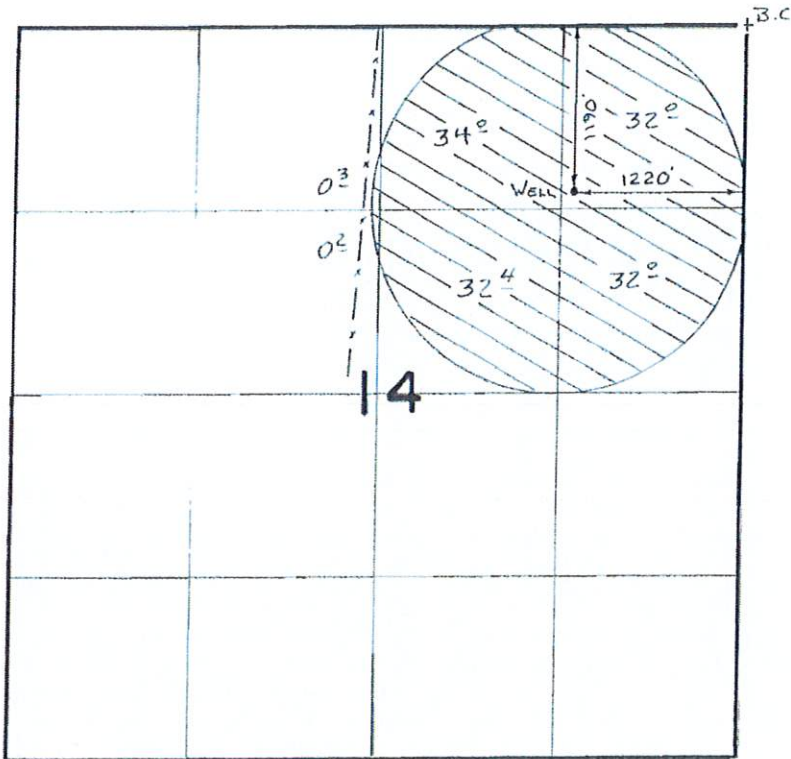

SCALE 1" = 1320'

**FINAL PROOF SURVEY**  
UNDER

Application No. **G:8916** Permit No. **G:8311**.....  
IN NAME OF

.....**ORAMARTIC, INC.**.....

Surveyed **5-7**..... 19**88**, by **J.M. Schmorde**.....

STATE OF OREGON  
COUNTY OF HARNEY  
CERTIFICATE OF WATER RIGHT

THIS CERTIFICATE ISSUED TO

OREGON DEPARTMENT OF STATE LANDS  
1645 NE FORBES RD SUITE 112  
BEND OR 97701

confirms the right to the use of water perfected under the terms of Permit G-17317. The amount of water used to which this right is entitled is limited to the amount used beneficially, and shall not exceed the amount specified, or its equivalent in the case of rotation, measured at the point of diversion from the source. The specific limits and conditions of the use are listed below.

APPLICATION FILE NUMBER: G-17705

SOURCE OF WATER: WELL 4 IN MALHEUR LAKE BASIN

PURPOSE or USE: IRRIGATION OF 125.2 ACRES

MAXIMUM RATE: 1.43 CUBIC FEET PER SECOND

PERIOD OF USE: MARCH 1 THROUGH OCTOBER 31

DATE OF PRIORITY: JULY 19, 2013

The well is located as follows:

Twp	Rng	Mer	Sec	Q-Q	Measured Distances
23 S	32 E	WM	10	NW SE	1323 FEET NORTH AND 1328 FEET WEST FROM SE CORNER, SECTION 10

The amount of water used for irrigation under this right, together with the amount secured under any other right existing for the same lands, is limited to a diversion of ONE-SIXTIETH of one cubic foot per second and 3.0 acre-feet for each acre irrigated during the irrigation season of each year.

A description of the place of use is as follows:

Twp	Rng	Mer	Sec	Q-Q	Acres
23 S	32 E	WM	10	NE SE	31.3
23 S	32 E	WM	10	NW SE	31.3
23 S	32 E	WM	10	SW SE	31.3
23 S	32 E	WM	10	SE SE	31.3

**NOTICE OF RIGHT TO PETITION FOR RECONSIDERATION OR JUDICIAL REVIEW**

This is an order in other than a contested case. This order is subject to judicial review under ORS 183.484 and ORS 536.075. Any petition for judicial review must be filed within the 60-day time period specified by ORS 183.484(2). Pursuant to ORS 183.484, ORS 536.075 and OAR 137-004-0080, you may petition for judicial review and petition the Director for reconsideration of this order. A petition for reconsideration may be granted or denied by the Director, and if no action is taken within 60 days following the date the petition was filed, the petition shall be deemed denied. In addition, under ORS 537.260 any person with an application, permit or water right certificate subsequent in priority may jointly or severally contest the issuance of the certificate within three months after issuance of the certificate.

Measurement devices, and recording/reporting conditions of annual water use conditions:

- A. The water user shall maintain, in good working order, a totalizing flow meter or other suitable measuring device as approved by the Director at each point of appropriation.
- B. The water user shall allow the watermaster access to the device; provided however, where any device is located within a private structure, the watermaster shall request access upon reasonable notice.
- C. The water user shall keep a complete record of the volume of water diverted each month, and shall submit a report which includes water-use measurements to the Department annually or more frequently as may be required by the Director. Further, the Director may require the water user to report general water-use information, including the place and nature of use of water under the right.
- D. The Director may provide an opportunity for the water user to submit alternative measuring and reporting procedures for review and approval.

The Department requires the water user to obtain, from a qualified individual (see below), and report annual static water levels for each well on the right. The static water level shall be measured in the month of March. Reports shall be submitted to the Department within 30 days of measurement.

The water user shall report annual March static water-level measurements whether or not the well is used. The reference level against which future measurements will be compared is 36.13 feet below ground surface. The Director may require the user to obtain and report additional water levels each year if more data are needed to evaluate the aquifer system.

All measurements shall be made by a certified water rights examiner, registered professional geologist, registered professional engineer, licensed well constructor or pump installer licensed by the Construction Contractors Board. Measurements shall be submitted on forms provided by, or specified by, the Department. Measurements shall be made with equipment that is accurate to at least the standards specified in OAR 690-217-0045. The Department requires the individual performing the measurement to:

- A. Associate each measurement with an owner's well name or number and a Department well log ID; and
- B. Report water levels to at least the nearest tenth of a foot as depth-to-water below ground surface; and
- C. Specify the method of measurement; and
- D. Certify the accuracy of all measurements and calculations reported to the Department.

The water user shall discontinue use of, or reduce the rate or volume of withdrawal from, the well(s) if any of the following events occur:

- A. Annual water-level measurements reveal an average water-level decline of three or more feet per year for five consecutive years; or
- B. Annual water-level measurements reveal a water-level decline of 15 or more feet in fewer than five consecutive years; or
- C. Annual water-level measurements reveal a water-level decline of 25 or more feet; or
- D. Hydraulic interference leads to a decline of 25 or more feet in any neighboring well with senior priority.

The period of restricted use shall continue until the water level rises above the decline level which triggered the action or the Department determines, based on the water user's and/or the Department's data and analysis, that no action is necessary because the aquifer in question can sustain the observed declines without adversely impacting the resource or causing substantial interference with senior water rights. The water user shall not allow excessive decline, as defined in Commission rules, to occur within the aquifer as a result of use under this right. If more than one well is involved, the water user may submit an alternative measurement and reporting plan for review and approval by the Department.

The user shall maintain one minimum six-inch diameter observation well to penetrate the same aquifer as the production well. The landowner or water user shall provide access to the Department staff to install and maintain the monitoring equipment. The well shall not be used for any other purpose while the Department is monitoring water levels.

The water user shall ensure that the well has been assigned an OWRD Well Identification Number (Well ID tag), which shall be permanently attached to the well. The Well ID shall be used as a reference in any correspondence regarding the well, including any reports of water use, water level, or pump test data.

Failure to comply with any of the provisions of this right may result in action including, but not limited to, restrictions on the use, civil penalties, or cancellation of the right.

If substantial interference with a senior water right occurs due to withdrawal of water from any well listed on this right, then use of water from the well(s) shall be discontinued or reduced and/or the schedule of withdrawal shall be regulated until or unless the Department approves or implements an alternative administrative action to mitigate the interference. The Department encourages junior and senior appropriators to jointly develop plans to mitigate interferences.

The well(s) shall be maintained in accordance with the General Standards for the Construction and Maintenance of Water Wells in Oregon. The works shall be equipped with a usable access port, and may also include an air line and pressure gauge adequate to determine the water level elevation in the well at all times.

The use may be restricted if the quality of downstream waters decreases to the point that those waters no longer meet state or federal water quality standards due to reduced flows.

Where two or more water users agree among themselves as to the manner of rotation in the use of water and such agreement is placed in writing and filed by such water users with the watermaster, and such rotation system does not infringe upon such prior rights of any water user not a party to such rotation plan, the watermaster shall distribute the water according to such agreement.

The Director may require water level or pump test results every ten years.

This right is for the beneficial use of water without waste. The water user is advised that new regulations may require the use of best practical technologies or conservation practices to achieve this end.

By law, the land use associated with this water use must be in compliance with statewide land-use goals and any local acknowledged land-use plan.

The right to the use of the water for the above purpose is restricted to beneficial use on the place of use described.

Issued JUN 09 2020.

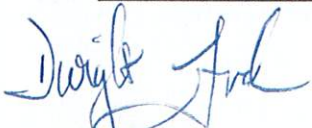

Dwight French  
Water Right Services Division Administrator, for  
Thomas M. Byler, Director  
Oregon Water Resources Department



# FINAL PROOF MAP

TO ADD PLACE OF USE &  
POINT OF APPROPRIATION  
FOR APPLICATION G-17705

TAX LOT: 1700 IN SECTION 10,  
TOWNSHIP 23 SOUTH, RANGE 32 EAST, W.M.

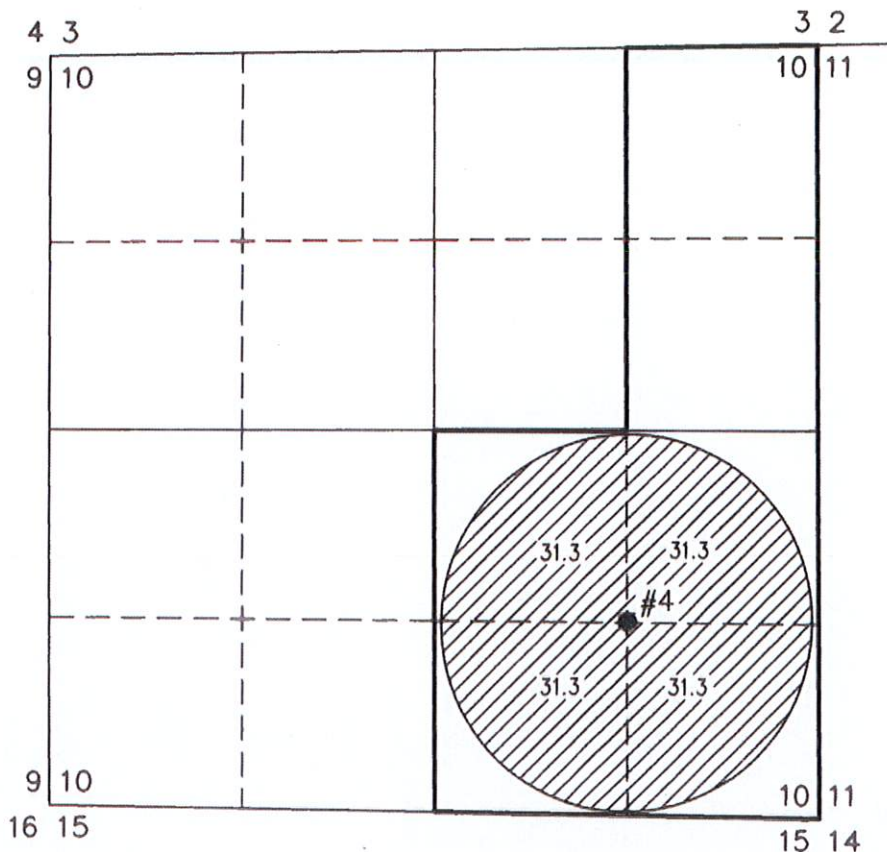

RECEIVED

JUL 25 2018

OWRD

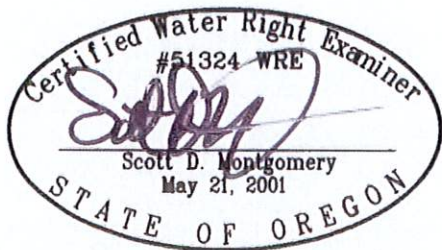

RENEWAL DATE: 12/31/2018

- #4 (HARN 52620)  
LOCATED IN THE NW 1/4 SE 1/4 SECTION 10, T23S R32E, W.M. AND 1323 FEET NORTH AND 1328 FEET WEST FROM THE SE CORNER OF SECTION 10. FLOW METER IS LOCATED 60 FEET SOUTH AND 60 FEET WEST OF WELL ON THE PIVOT SPRINKLER.



125.2 ACRES 'IR' RIGHTS FROM #4  
PER G-17317, AS SHOWN.

THIS MAP IS FOR THE PURPOSE OF LOCATING A WATER RIGHT ONLY AND HAS NO INTENT TO PROVIDE LEGAL DIMENSIONS OR THE LOCATION OF PROPERTY LINES.

PREPARED FOR:

OREGON DEPT. OF STATE LANDS  
1645 NE FORBES ROAD, SUITE 112  
BEND, OR 97701

PREPARED BY:



ALL POINTS ENGINEERING AND SURVEYING, INC.  
P.O. BOX 767 TERREBONNE, OR 97760  
(541) 548-5833 www.APEandS.com

**NOTICE TO WATER WELL CONTRACTOR**

The original and first copy of this report are to be filed with the

STATE ENGINEER, SALEM 10, OREGON within 30 days from the date of well completion.

**RECEIVED**

OCT 21 1963  
G5439

**WATER WELL REPORT**

STATE OF OREGON  
(Please type or print)

In the name of Patricia Hayes

565

State Well No. 23/32-13b

State Permit No.

**(1) OWNER:**

Name Elton E. Sneed  
Address 642 Girard St San Francisco Calif

**(2) LOCATION OF WELL:**

County HARNEY Driller's well number  
NW 1/4 1/4 Section 13 T. 23S R. 32E W.M.  
Bearing and distance from section or subdivision corner  
50 ft east 200 ft south of NW  
North west corner of the NW1/4  
of sec. 13

**(3) TYPE OF WORK (check):**

Well  Deepening  Reconditioning  Abandon   
Abandonment, describe material and procedure in Item 12.

**(4) PROPOSED USE (check):**

Domestic  Industrial  Municipal   
Irrigation  Test Well  Other

**(5) TYPE OF WELL:**

Rotary  Driven   
Cable  Jetted   
Dug  Bored

**(6) CASING INSTALLED:**

Threaded  Welded   
14" Diam. from 0 ft. to 232 ft. Gage 1/4 in.  
" Diam. from " ft. to " ft. Gage  
" Diam. from " ft. to " ft. Gage

**(7) PERFORATIONS:**

Perforated?  Yes  No  
Type of perforator used Mill Cut  
Size of perforations 3/16 in. by 3 in.  
8000 perforations from 72 ft. to 240 ft.  
perforations from " ft. to " ft.  
perforations from " ft. to " ft.  
perforations from " ft. to " ft.

**(8) SCREENS:**

Well screen installed  Yes  No  
Manufacturer's Name  
Model No.  
Diam. Slot size Set from " ft. to " ft.  
Diam. Slot size Set from " ft. to " ft.

**(9) CONSTRUCTION:**

Well seal—Material used in seal cement  
Depth of seal 18 ft. Was a packer used? no  
Diameter of well bore to bottom of seal 24 in.  
Were any loose strata cemented off?  Yes  No Depth  
Was a drive shoe used?  Yes  No  
Was well gravel packed?  Yes  No Size of gravel: 3/4 minus  
Gravel placed from 18 ft. to 232 ft.  
Did any strata contain unusable water?  Yes  No  
Type of water? Depth of strata  
Method of sealing strata off

**(10) WATER LEVELS:**

Static level 13 ft. below land surface Date 10/22/63  
Artesian pressure lbs. per square inch Date

**(11) WELL TESTS:**

Drawdown is amount water level is lowered below static level  
Was a pump test made?  Yes  No If yes, by whom?  
Field: gal./min. with ft. drawdown after hrs.  
" " " " "  
" " " " "  
" " " " "  
Baller test 100 gal./min. with no ft. drawdown after 3 hrs.  
Artesian flow g.p.m. Date  
Temperature of water Was a chemical analysis made?  Yes  No

**(12) WELL LOG:**

Diameter of well below casing  
Depth drilled 232 ft. Depth of completed well 232 ft.  
Formation: Describe by color, character, size of material and structure, and show thickness of aquifers and the kind and nature of the material in each stratum penetrated, with at least one entry for each change of formation.

MATERIAL	FROM	TO
Top soil	0	8
Br Clay	8	46
Blue Clay	46	66
Gravel Course	66	72
Clay Blue	72	103
Gravel Course	103	111
Clay Blue	111	158
Gravel Med	158	163
Clay Blue	163	188
Gravel Med	188	195
Clay Blue	195	203
Gravel Course	203	230
Hard Rock	230	232

This well is 24 in with 14 in casing  
gravel packed with a cement seal at  
18 ft with a 6 in. X 1/4 in. gravel  
chute

Will be tested this week by  
Eastern Oregon Mills Of Bend, Ore.

Work started Oct 15 1963 Completed Oct 21 1963  
Date well drilling machine moved off of well Oct 23 1963

**(13) PUMP:**

Manufacturer's Name  
Type: H.P.

**Water Well Contractor's Certification:**

This well was drilled under my jurisdiction and this report is true to the best of my knowledge and belief.

NAME McGuire Drilling Co.  
(Person, firm or corporation) (Type or print)

Address Box 909 Burns, Oregon

Drilling Machine Operator's License No. 81

[Signed] J. C. McGuire  
(Water Well Contractor)

Contractor's License No. 383 Date Oct 23, 1963.

STATE OF OREGON  
 WATER SUPPLY WELL REPORT  
 (as required by ORS 537.765 & OAR 690-205-0210)

HARN 52114

HARN 52114

WELL LABEL # L 115913

START CARD # 211192

Instructions for completing this report are on the last page of this form.

(1) LAND OWNER Owner Well I.D.  
 First Name Stephen Last Name Roth  
 Company \_\_\_\_\_  
 Address 41600 Hwy 20  
 City Brother State OR Zip 97712

(2) TYPE OF WORK  New Well  Deepening  Conversion  
 Alteration (repair/recondition)  Abandonment

(3) DRILL METHOD  
 Rotary Air  Rotary Mud  Cable  Auger  Cable Mud  
 Reverse Rotary  Other \_\_\_\_\_

(4) PROPOSED USE  Domestic  Irrigation  Community  
 Industrial/Commercial  Livestock  Dewatering  Injection  
 Thermal  Other \_\_\_\_\_

(5) BORE HOLE CONSTRUCTION Special Standard:  Yes (attach copy)  
 Depth of Completed Well 820 ft.

BORE HOLE			SEAL				
Dia	From	To	Material	From	To	Amount	Scks/lbs
12"	28	820					

How was seal placed: Method  A  B  C  D  E  
 Other \_\_\_\_\_

Backfill placed from \_\_\_\_\_ ft. to \_\_\_\_\_ ft. Material \_\_\_\_\_  
 Filter pack from \_\_\_\_\_ ft. to \_\_\_\_\_ ft. Material \_\_\_\_\_ Size \_\_\_\_\_  
 Explosives used:  Yes Type \_\_\_\_\_ Amount \_\_\_\_\_

(6) CASING/LINER

Casing	Linr	Dia	+	From	To	Gauge	Steel	Plastic	Welded	Thrd

Shoe  Inside  Outside  Other Location of shoe(s) SALEM, OR  
 Temporary casing  Yes Diameter \_\_\_\_\_ From \_\_\_\_\_ To \_\_\_\_\_

(7) PERFORATIONS/SCREENS

Perforations Method \_\_\_\_\_  
 Screens Type \_\_\_\_\_ Material \_\_\_\_\_

Perf	Scrn	Casing	Linr	Screen Dia	From	To	Screen/slot width	Slot length	# of slots	Tele/pipe size

(8) WELL TESTS: Minimum testing time is 1 hour

Pump  Bailer  Air  Flowing Artesian  
 Yield gal/min 500 sil Drawdown \_\_\_\_\_ Drill stem/Pump depth 820 Duration (hr) hour

Temperature 60 °F Lab analysis  Yes By \_\_\_\_\_  
 Water quality concerns?  Yes (describe below)

From	To	Description	Amount	Units

(9) LOCATION OF WELL (legal description)

County HASSEL Twp 22 N or S Range 20 E or W W.M.  
 Sec 14 NE 1/4 of the NE 1/4 Tax Lot 1900  
 Tax Map Number \_\_\_\_\_ Lot \_\_\_\_\_  
 Lat \_\_\_\_\_ " or \_\_\_\_\_ " DMS or DD  
 Long \_\_\_\_\_ " or \_\_\_\_\_ " DMS or DD

Street Address of Well (or nearest address) 5 Haker Rd  
going South 2 mile in 2 mile to RIGHT

(10) STATIC WATER LEVEL

	Date	SWL (psi)	+	SWL (ft)
Existing Well/Predeepening	<u>9-8-14</u>			<u>33'</u>
Completed Well	<u>9-1-14</u>			<u>33'</u>

Flowing Artesian?  Yes Dry Hole?  Yes

WATER BEARING ZONES Depth water was first found

SWL Date	From	To	Est Flow	SWL (psi)	+	SWL (ft)
	<u>NO</u>					
			<u>water was</u>			
			<u>Encountered</u>			

(11) WELL LOG

Material	From	To	Ground Elevation
<u>Blue clay</u>	<u>280</u>	<u>360</u>	
<u>Green clay</u>	<u>360</u>	<u>470</u>	
<u>Blueish gray clay</u>	<u>470</u>	<u>480</u>	
<u>gray clay</u>	<u>480</u>	<u>525</u>	
<u>Brown clay</u>	<u>525</u>	<u>595</u>	
<u>Blue clay</u>	<u>595</u>	<u>690</u>	
<u>gray clay</u>	<u>690</u>	<u>745</u>	
<u>Blue clay</u>	<u>745</u>	<u>795</u>	
<u>gray clay</u>	<u>795</u>	<u>820</u>	

Date Started 8-27-14 Completed 8-1-14

(unbonded) Water Well Constructor Certification

I certify that the work I performed on the construction, deepening, alteration, or abandonment of this well is in compliance with Oregon water supply well construction standards. Materials used and information reported above are true to the best of my knowledge and belief.

License Number \_\_\_\_\_ Date \_\_\_\_\_

Signed \_\_\_\_\_

(bonded) Water Well Constructor Certification

I accept responsibility for the construction, deepening, alteration, or abandonment work performed on this well during the construction dates reported above. All work performed during this time is in compliance with Oregon water supply well construction standards. This report is true to the best of my knowledge and belief.

License Number 1654 Date 10-15-14

Signed [Signature]

Contact Info. (optional) Tom Scaren  
541-576-2189

**HARN 52620**

WELL I.D. LABEL# 125278  
 START CARD# 2125108  
 ORIGINAL LOG#

(1) LAND OWNER  
 First Name \_\_\_\_\_ Owner Well I.D. \_\_\_\_\_  
 Last Name \_\_\_\_\_  
 Company State Department of State Lands  
 Address 1645 FOLBOS RD SUITE 112  
 City \_\_\_\_\_ State \_\_\_\_\_ Zip \_\_\_\_\_

(2) TYPE OF WORK  New Well  Deepening  Conversion  
 Alteration (complete 2a & 10)  Abandonment (complete 5a)

(2a) PRE-ALTERATION  
 Dia + From To Gauge Stl Plste Wld Thrd  
 Casing:          
 Seal: \_\_\_\_\_

(3) DRILL METHOD  
 Rotary Air  Rotary Mud  Cable  Auger  Cable Mud  
 Reverse Rotary  Other \_\_\_\_\_

(4) PROPOSED USE  Domestic  Irrigation  Community  
 Industrial/ Commercial  Livestock  Dewatering  
 Thermal  Injection  Other \_\_\_\_\_

(5) BORE HOLE CONSTRUCTION Special Standard  (Attach copy)  
 Depth of Completed Well 390 ft.

BORE HOLE		SEAL		sacks/lbs	
Dia	From To	Material	From To	Amt	lbs
20"	0 80	Bent	0 80	165	544
12"	80 390			Calculated	87
12"	290 390			Calculated	87

How was seal placed: Method  A  B  C  D  E  
 Other Bent 3 mi. Pipe  
 Backfill placed from \_\_\_\_\_ ft. to \_\_\_\_\_ ft. Material \_\_\_\_\_  
 Filter pack from \_\_\_\_\_ ft. to \_\_\_\_\_ ft. Material \_\_\_\_\_ Size \_\_\_\_\_  
 Explosives used:  Yes Type \_\_\_\_\_ Amount \_\_\_\_\_

(5a) ABANDONMENT USING UNHYDRATED BENTONITE  
 Proposed Amount Pounds Actual Amount Pounds

(6) CASING/LINER  

Casing/Liner	Dia	+	From	To	Gauge	Stl	Plste	Wld	Thrd
<input checked="" type="checkbox"/>	16"	+	1	39	.150	<input checked="" type="checkbox"/>	<input type="checkbox"/>	<input checked="" type="checkbox"/>	<input type="checkbox"/>
<input checked="" type="checkbox"/>	12"	=	1"	290	.150	<input checked="" type="checkbox"/>	<input type="checkbox"/>	<input checked="" type="checkbox"/>	<input checked="" type="checkbox"/>

 Shoe  Inside  Outside  Other Location of shoe(s) \_\_\_\_\_  
 Temp casing  Yes Dia \_\_\_\_\_ From \_\_\_\_\_ To \_\_\_\_\_

(7) PERFORATIONS/SCREENS  
 Perforations Method Michael  
 Screens Type \_\_\_\_\_ Material \_\_\_\_\_  

Perf/S	Casing/Screen	green	Liner	Dia	From	To	Scrns/slot width	Slot length	# of slots	Tele/ pipe size
X	12"			160	390	3/8	3"	10.00		

(8) WELL TESTS: Minimum testing time is 1 hour  
 Pump  Bailer  Air  Flowing Artesian  

Yield gal/min	Drawdown	Drill stem/Pump depth	Duration (hr)
1500		390	1.12

Temperature 53' °F Lab analysis  Yes By \_\_\_\_\_  
 Water quality concerns?  Yes (describe below) TDS amount 280  
 From \_\_\_\_\_ To \_\_\_\_\_ Description \_\_\_\_\_ Amount \_\_\_\_\_ Units \_\_\_\_\_

(9) LOCATION OF WELL (legal description)  
 County Hallam Twp 23 N/S Range 32 E/W WM  
 Sec 10 SE 1/4 of the 1/4 1/4 Tax Lot 1500  
 Tax Map Number \_\_\_\_\_ Lot \_\_\_\_\_  
 Lat \_\_\_\_\_ " or \_\_\_\_\_ DMS or DD  
 Long \_\_\_\_\_ " or \_\_\_\_\_ DMS or DD  
 Street address of well  Nearest address

1 mile post 142 Hwy out of Brins  
from right turn

(10) STATIC WATER LEVEL  
 Date \_\_\_\_\_ SWL (psi) + SWL (ft)  
 Existing Well / Pre-Alteration \_\_\_\_\_  
 Completed Well 5-30-16 \_\_\_\_\_ 65'  
 Flowing Artesian?  Dry Hole?

WATER BEARING ZONES Depth water was first found 60

SWL Date	From	To	Est Flow	SWL (psi)	+ SWL (ft)
5-30-16	60	15	25 gal		65'
5-30-16	100	290	300 gal		65'

(11) WELL LOG Ground Elevation \_\_\_\_\_

Material	From	To
TOP SOIL	0	502
Gray Clay	255	55
White Clay	65	75
Black Placed Granite	65	75
Gray Clay	75	85
Black Sand with gravel	85	290
White Clay	290	390
Black Clay Gray	390	500

RECEIVED BY OWRD  
 RECEIVED BY OWRD JAN 03 2017  
 MAR 06 2017 SALEM, OR  
 SALEM, OR  
 Date Started 5-17-16 Completed 5-30-16

(unbonded) Water Well Constructor Certification  
 I certify that the work I performed on the construction, deepening, alteration, or abandonment of this well is in compliance with Oregon water supply well construction standards. Materials used and information reported above are true to the best of my knowledge and belief.  
 License Number \_\_\_\_\_ Date \_\_\_\_\_  
 Signed \_\_\_\_\_

(bonded) Water Well Constructor Certification  
 I accept responsibility for the construction, deepening, alteration, or abandonment work performed on this well during the construction dates reported above. All work performed during this time is in compliance with Oregon water supply well construction standards. This report is true to the best of my knowledge and belief.  
 License Number 1654 Date 12-29-16  
 Signed \_\_\_\_\_  
 Contact Info (optional) \_\_\_\_\_



**HARN 52621**

WELL I.D. LABEL# I 125279  
START CARD# 212522  
ORIGINAL LOG#

(1) LAND OWNER  
Owner Well I.D. \_\_\_\_\_  
First Name \_\_\_\_\_ Last Name \_\_\_\_\_  
Company DEPARTMENT OF STATE LAND  
Address 1145 NE FORBES RD SUITE 112  
City Bent State OR Zip 97704

(2) TYPE OF WORK  New Well  Deepening  Conversion  
 Alteration (complete 2a & 10)  Abandonment (complete 5a)

(2a) PRE-ALTERATION  
Dia + From To Gauge St Plstc Wld Thr  
Casing:          
Material From To Amt sacks/lbs  
Seal:

(3) DRILL METHOD  
 Rotary Air  Rotary Mud  Cable  Auger  Cable Mud  
 Reverse Rotary  Other \_\_\_\_\_

(4) PROPOSED USE  Domestic  Irrigation  Community  
 Industrial/ Commercial  Livestock  Dewatering  
 Thermal  Injection  Other \_\_\_\_\_

(5) BORE HOLE CONSTRUCTION Special Standard  (Attach copy)  
Depth of Completed Well 400 ft.

BORE HOLE			SEAL			Amt	sacks/lbs
Dia	From	To	Material	From	To		
20"	0	79	Bent	0	79	80	5 sack
16"	79	280				55	5 sack
16"	280	400				80	5 sack
						55	

How was seal placed: Method  A  B  C  D  E  
 Other Bent 3 mm pack  
Backfill placed from \_\_\_\_\_ ft. to \_\_\_\_\_ ft. Material \_\_\_\_\_  
Filter pack from \_\_\_\_\_ ft. to \_\_\_\_\_ ft. Material \_\_\_\_\_ Size \_\_\_\_\_  
Explosives used:  Yes Type \_\_\_\_\_ Amount \_\_\_\_\_

(5a) ABANDONMENT USING UNHYDRATED BENTONITE  
Proposed Amount \_\_\_\_\_ Pounds Actual Amount \_\_\_\_\_ Pounds

(6) CASING/LINER  
Casing Liner Dia + From To Gauge St Plstc Wld Thr  
  16" +1 79 280      
  -5 280 280      
Shoe  Inside  Outside  Other Location of shoe(s) \_\_\_\_\_  
Temp casing  Yes Dia \_\_\_\_\_ From \_\_\_\_\_ To \_\_\_\_\_

(7) PERFORATIONS/SCREENS Method Michigan  
Screens Type \_\_\_\_\_ Material \_\_\_\_\_  
Perf/S Casing/Screen Dia From To Scrm/slot Slot # of Tele/ pipe size  
reen Liner Dia From To width length slots pipe size  
 X 12" 280 160 3x4 3" 1/2"

(8) WELL TESTS: Minimum testing time is 1 hour  
 Pump  Bailer  Air  Flowing Artesian  
Yield gal/min Drawdown Drill stem/Pump depth Duration (hr)  
800 \_\_\_\_\_ 400 gal hr

Temperature 53 °F Lab analysis  Yes By \_\_\_\_\_  
Water quality concerns?  Yes (describe below) TDS amount 290  
From To Description Amount Units

(9) LOCATION OF WELL (legal description)  
County Harmy Twp 23 N/S Range 32 E/W WM  
Sec 14 SE 1/4 of the SW 1/4 Tax Lot 190  
Tax Map Number \_\_\_\_\_ Lot \_\_\_\_\_  
Lat \_\_\_\_\_ " or \_\_\_\_\_ DMS or DD  
Long \_\_\_\_\_ " or \_\_\_\_\_ DMS or DD  
Street address of well \_\_\_\_\_ Nearest address \_\_\_\_\_

milepost 142 east Bent Turn High 90  
1 mile

(10) STATIC WATER LEVEL  
Date \_\_\_\_\_ SWL (psi) + SWL (ft)  
Existing Well / Pre-Alteration \_\_\_\_\_  
Completed Well \_\_\_\_\_ 65  
Flowing Artesian?  Dry Hole?

WATER BEARING ZONES Depth water was first found 60'

SWL Date	From	To	Est Flow	SWL (psi)	+ SWL (ft)

(11) WELL LOG Ground Elevation \_\_\_\_\_  
Material From To  
TOP SOIL 0 2  
CLAY 2 87  
Black sand 87 280  
gray clay 280 400  
**RECEIVED BY OWRD**  
**RECEIVED BY OWRD 03 2017**  
**MAR 06 2017 SALEM, OR**  
**SALEM, OR**

Date Started 5-31-16 Completed 6-24-16

(unbonded) Water Well Constructor Certification  
I certify that the work I performed on the construction, deepening, alteration, or abandonment of this well is in compliance with Oregon water supply well construction standards. Materials used and information reported above are true to the best of my knowledge and belief.  
License Number \_\_\_\_\_ Date \_\_\_\_\_  
Signed \_\_\_\_\_

(bonded) Water Well Constructor Certification  
I accept responsibility for the construction, deepening, alteration, or abandonment work performed on this well during the construction dates reported above. All work performed during this time is in compliance with Oregon water supply well construction standards. This report is true to the best of my knowledge and belief.  
License Number 1651 Date 12-21-16  
Signed \_\_\_\_\_  
Contact Info (optional): \_\_\_\_\_

# Revisions Requested

First Name \_\_\_\_\_ Last Name \_\_\_\_\_  
 Company Department of State Land  
 Address 1645 NE Sobies rd suite 112  
 City Bend State OR Zip 97701

(2) TYPE OF WORK  New Well  Deepening  Conversion  
 Alteration (complete 2a & 10)  Abandonment (complete 5a)

(2a) PRE-ALTERATION  
 Casing: Dia + From To Gauge Stl Plstc Wld Thr  
 Material From To Amt sacks/lbs  
 Seal: \_\_\_\_\_

(3) DRILL METHOD  
 Rotary Air  Rotary Mud  Cable  Auger  Cable Mud  
 Reverse Rotary  Other \_\_\_\_\_

(4) PROPOSED USE  Domestic  Irrigation  Community  
 Industrial/ Commercial  Livestock  Dewatering  
 Thermal  Injection  Other \_\_\_\_\_

(5) BORE HOLE CONSTRUCTION Special Standard  (Attach copy)  
 Depth of Completed Well 460 ft.

BORE HOLE			SEAL			Amt	sacks/lbs
Dia	From	To	Material	From	To		
24"	0	79	Bent	0	79	144	SK
16"	79	250				Calculated	
10"	250	460				Calculated	

How was seal placed: Method  A  B  C  D  E  
 Other Bent 3 min pack

Backfill placed from \_\_\_\_\_ ft. to \_\_\_\_\_ ft. Material \_\_\_\_\_

Filter pack from \_\_\_\_\_ ft. to \_\_\_\_\_ ft. Material \_\_\_\_\_ Size \_\_\_\_\_

Explosives used:  Yes Type \_\_\_\_\_ Amount \_\_\_\_\_

(5a) ABANDONMENT USING UNHYDRATED BENTONITE  
 Proposed Amount Pounds Actual Amount Pounds

(6) CASING/LINER

Casing	Liner	Dia	+	From	To	Gauge	Stl	Plstc	Wld	Thrd
<input checked="" type="checkbox"/>	<input checked="" type="checkbox"/>	16"	+	1	79	.250	<input checked="" type="checkbox"/>	<input type="checkbox"/>	<input checked="" type="checkbox"/>	<input type="checkbox"/>
<input type="checkbox"/>	<input type="checkbox"/>	12"	+	15	250	.250	<input checked="" type="checkbox"/>	<input type="checkbox"/>	<input checked="" type="checkbox"/>	<input type="checkbox"/>

Shoe  Inside  Outside  Other Location of shoe(s) \_\_\_\_\_

Temp casing  Yes Dia \_\_\_\_\_ From \_\_\_\_\_ To \_\_\_\_\_

(7) PERFORATIONS/SCREENS

Perforations Method \_\_\_\_\_

Screens Type \_\_\_\_\_ Material \_\_\_\_\_

Perf/S	Casing/Screen	Liner	Dia	From	To	Scrns/slot width	Slot length	# of slots	Teel/ pipe size
			12"	120	250	1/2"	3"	3360	

(8) WELL TESTS: Minimum testing time is 1 hour

Pump  Bailer  Air  Flowing Artesian

Yield gal/min	Drawdown	Drill stem/Pump depth	Duration (hr)
300 gal		460	1 hr

Temperature 52 °F Lab analysis  Yes By \_\_\_\_\_

Water quality concerns?  Yes (describe below) TDS amount 300  
 From - To Description Amount Units

From	To	Description	Amount	Units

(9) LOCATION OF WELL (legal description)

County Wheeler Twp 23 N/S Range 32 E/W WM  
 Sec 14 SE 1/4 of the NW 1/4 Tax Lot 1900  
 Tax Map Number \_\_\_\_\_ Lot \_\_\_\_\_  
 Lat \_\_\_\_\_ " or \_\_\_\_\_ DMS or DD  
 Long \_\_\_\_\_ " or \_\_\_\_\_ DMS or DD  
 Street address of well  Nearest address

(10) STATIC WATER LEVEL

Existing Well / Pre-Alteration	Date	SWL(psi)	+ SWL(ft)
Completed Well <del>05-17</del>	<u>9-29-17</u>		<u>65 ft</u>

Flowing Artesian?  Dry Hole?

WATER BEARING ZONES

Depth water was first found \_\_\_\_\_

SWL Date	From	To	Est Flow	SWL(psi)	+ SWL(ft)
9-29-17	120	460	300 gpm		65"

(11) WELL LOG

Ground Elevation \_\_\_\_\_

Material	From	To
top soil	0	2
blue green clay	2	30
clay blue	30	120
gravel/sand	120	280
black gray sand	280	300
gray sand	300	340
general gray sand	340	460

RECEIVED BY OWRD

JUL 10 2017

SALEM, OR

Date Started 6-28-17 Completed 6-29-17

(unbonded) Water Well Constructor Certification

I certify that the work I performed on the construction, deepening, alteration, or abandonment of this well is in compliance with Oregon water supply well construction standards. Materials used and information reported above are true to the best of my knowledge and belief.

License Number \_\_\_\_\_ Date \_\_\_\_\_

Signed \_\_\_\_\_

(bonded) Water Well Constructor Certification

I accept responsibility for the construction, deepening, alteration, or abandonment work performed on this well during the construction dates reported above. All work performed during this time is in compliance with Oregon water supply well construction standards. This report is true to the best of my knowledge and belief.

License Number 1654 Date 7-5-15

Signed \_\_\_\_\_

Contact Info (optional) \_\_\_\_\_

(1) LAND OWNER  
 Owner Well I.D. \_\_\_\_\_  
 First Name \_\_\_\_\_ Last Name \_\_\_\_\_  
 Company Department of state lands  
 Address 1645 NE Forbes RD suite 112  
 City Bend State OR Zip 97701

(2) TYPE OF WORK  New Well  Deepening  Conversion  
 Alteration (complete 2a & 10)  Abandonment (complete 5a)

(2a) PRE-ALTERATION  
 Dia + From To Gauge Stl Plstc Wld Thrd  
 Casing: [ ] [ ] [ ] [ ] [ ] [ ] [ ] [ ]  
 Seal: [ ] [ ] [ ] [ ] [ ] [ ] [ ] [ ]

(3) DRILL METHOD  
 Rotary Air  Rotary Mud  Cable  Auger  Cable Mud  
 Reverse Rotary  Other \_\_\_\_\_

(4) PROPOSED USE  Domestic  Irrigation  Community  
 Industrial/ Commercial  Livestock  Dewatering  
 Thermal  Injection  Other \_\_\_\_\_

(5) BORE HOLE CONSTRUCTION Special Standard  (Attach copy)  
 Depth of Completed Well 420 ft.  
 BORE HOLE SEAL  

Dia	From	To	Material	From	To	Amt	sacks/ lbs
24"	0	79	Bent	0	79	144	50
16"	79	315				Calculated	30
10"	315	420				Calculated	

 How was seal placed: Method  A  B  C  D  E  
 Other Bent 3 mm PVC  
 Backfill placed from \_\_\_\_\_ ft. to \_\_\_\_\_ ft. Material \_\_\_\_\_  
 Filter pack from \_\_\_\_\_ ft. to \_\_\_\_\_ ft. Material \_\_\_\_\_ Size \_\_\_\_\_  
 Explosives used:  Yes Type \_\_\_\_\_ Amount \_\_\_\_\_

(5a) ABANDONMENT USING UNHYDRATED BENTONITE  
 Proposed Amount \_\_\_\_\_ Pounds Actual Amount \_\_\_\_\_ Pounds

(6) CASING/LINER  

Casing	Liner	Dia	+	From	To	Gauge	Stl	Plstc	Wld	Thrd
<input checked="" type="checkbox"/>	<input type="checkbox"/>	16"	+	1	79	.250	<input checked="" type="checkbox"/>	<input type="checkbox"/>	<input type="checkbox"/>	<input type="checkbox"/>
<input type="checkbox"/>	<input checked="" type="checkbox"/>	12"	-	15	315	.250	<input checked="" type="checkbox"/>	<input type="checkbox"/>	<input type="checkbox"/>	<input checked="" type="checkbox"/>

 Shoe  Inside  Outside  Other Location of shoe(s) \_\_\_\_\_  
 Temp casing  Yes Dia \_\_\_\_\_ From \_\_\_\_\_ To \_\_\_\_\_

(7) PERFORATIONS/SCREENS  
 Perforations Method Factory  
 Screens Type \_\_\_\_\_ Material \_\_\_\_\_  

Perf/S	Casing/	Screen	Scrn/slot	Slot	# of	Tele/
green	Liner	Dia	width	length	slots	pipe size
	+	12"	175	315	18	3.11

 5600

(8) WELL TESTS: Minimum testing time is 1 hour  
 Pump  Bailor  Air  Flowing Artesian  

Yield gal/min	Drawdown	Drill stem/Pump depth	Duration (hr)
300 gpm		420	1
estimated			

 Temperature 56 °F Lab analysis  Yes By \_\_\_\_\_  
 Water quality concerns?  Yes (describe below) TDS amount 280  

From	To	Description	Amount	Units

(9) LOCATION OF WELL (legal description)  
 County Hecney Twp 23 N8 Range 32 @ W WM  
 Sec 10 SE 1/4 of the NW 1/4 Tax Lot 1500  
 Tax Map Number \_\_\_\_\_ Lot \_\_\_\_\_  
 Lat \_\_\_\_\_ " or \_\_\_\_\_ DMS or DD  
 Long \_\_\_\_\_ " or \_\_\_\_\_ DMS or DD  
 Street address of well  Nearest address

Hwy 20 in burn between 142 and 143 acres  
 9 front

(10) STATIC WATER LEVEL  

Existing Well / Pre-Alteration	Date	SWL (psi)	+ SWL (ft)
Completed Well	6-2-17		63

 Flowing Artesian?  Dry Hole?   
 WATER BEARING ZONES Depth water was first found 45  

SWL Date	From	To	Est Flow	SWL (psi)	+ SWL (ft)
5/27/17	45	45 1/2	5 gal		15'
6-2-17	100	315	300 gal		63'

(11) WELL LOG  
 Ground Elevation \_\_\_\_\_  

Material	From	To
top soil	0	2
Broken gray clay w. B	2	45
brown clay	45	95
grayish clay	95	120
fractured gray clay/sand	120	280
pumice	280	300
gray clay	300	315
cubed clay	315	330
fractured clay	330	365
pumice	365	402
fractured clay/sand	402	420

 RECEIVED BY OWRD  
 JUN 15 2017  
 JUL 10 2017  
 SALEM, OR  
 SALEM, OR  
 Date Started 5-26-17 Completed 6-2-17

(unbonded) Water Well Constructor Certification  
 I certify that the work I performed on the construction, deepening, alteration, or abandonment of this well is in compliance with Oregon water supply well construction standards. Materials used and information reported above are true to the best of my knowledge and belief.  
 License Number \_\_\_\_\_ Date \_\_\_\_\_  
 Signed \_\_\_\_\_

(bonded) Water Well Constructor Certification  
 I accept responsibility for the construction, deepening, alteration, or abandonment work performed on this well during the construction dates reported above. All work performed during this time is in compliance with Oregon water supply well construction standards. This report is true to the best of my knowledge and belief.  
 License Number 1654 Date 6-9-17  
 Signed \_\_\_\_\_  
 Contact Info (optional) \_\_\_\_\_