



**TENNESSEE DEPARTMENT OF ENVIRONMENT AND CONSERVATION
DIVISION OF WATER RESOURCES
PERMIT FOR CONSTRUCTION OF SUBSURFACE SEWAGE DISPOSAL SYSTEM**

Issued to: <u>Dustin Moore</u> Owner, Developer, Contractor, Installer, Etc. Location: <u>Stevia Way</u> , TN - County: <u>Cocke</u> Map/Group: - Parcel: <u>0</u> Subdivision: <u>Misty Acres 2</u> Lot: <u>41</u>	Evaluation Based Upon: <input checked="" type="checkbox"/> 1. Soil Typing by Soil Scientist <input type="checkbox"/> a. General <input checked="" type="checkbox"/> b. High Intensity <input type="checkbox"/> c. Extra High Intensity <input type="checkbox"/> 2. Soil Percolation Test <input type="checkbox"/> 3. Environmental Specialist Estimated Absorption Rate: <u>60</u> MPI	Type of System: <input checked="" type="checkbox"/> 1. Conventional <input type="checkbox"/> 2. Modified Conventional <input checked="" type="checkbox"/> 3. Conventional System Substitute <input checked="" type="checkbox"/> Chamber <input checked="" type="checkbox"/> Expanded Polystyrene <input checked="" type="checkbox"/> Large Diameter Gravelless Pipe Gravel backfill in a 24" wide trench <u>no</u> required? <input type="checkbox"/> 4. Low Pressure Pipe <input type="checkbox"/> 5. Mound <input type="checkbox"/> 6. Lagoon <input type="checkbox"/> 7. Subsurface Drip System <input type="checkbox"/> 8. Other
Installation: <input checked="" type="checkbox"/> 1. New Installation <input type="checkbox"/> 2. Repair to Existing System <input type="checkbox"/> 3. System Modification	Approval Based Upon: State No. <u>T.C.A. 68-221-403</u> <input type="checkbox"/> (c) Percolation Test <input type="checkbox"/> (d) Grandfather clause - Current standards except those specified <input type="checkbox"/> (f) 12" (karst) and 6" (non-karst) buffer required <input type="checkbox"/> (i) 9" buffer required (24"-36" total soil depth) <input type="checkbox"/> (k) Grandfather clause - meets June 30, 1990 standards (repair only) <input checked="" type="checkbox"/> Current Standards <input type="checkbox"/> Other: _____	
Establishment: <input checked="" type="checkbox"/> 1. Residential: # Bedrooms <u>3</u> <input type="checkbox"/> 2. Other: _____ Gal/Day <u>0</u>		

This system shall consist of a two compartment septic tank holding 900 gallons, with 330 linear feet in 4-6 trenches, 36 inches wide and 24 (min) to 28 (max) inches deep. (Depth of gravel: 12 inches)

General Comments: Keep 10' from property lines and utilities, 25' from cut banks and drains 50' from any well. Call 423-736-2888 for inspection M W F 8-9am. 18" trench using 1401 or LDGP without rock

Also required:

- 1. Soil Improvement Practice (SIP)
 - Curtain Drain
 - Drawdown Drain
 - Interceptor Drain
- 2. Flow Diversion Valve
- 3. Sewage Pump
 - Pump Flow Rate (gpm) _____
 - TDH (ft) _____
- 4. Other: **Single compartment pump tank. Electrical inspection required prior to field inspection.**

All installers of subsurface sewage disposal systems must hold a valid annual license from the Tennessee Department of Environment and Conservation.

Please see attached drawing and supporting documentation.

The recipient of this permit agrees to construct or have constructed the above described system in accordance with T.C.A. 68-221-401 et. seq. and The Regulations To Govern Subsurface Sewage Disposal Systems. If any part of the system is covered before inspected and approved, it shall be uncovered by the recipient of the permit at the direction of personnel of the Department of Environment and Conservation. **Any cutting, filling or alterations of the soil conditions on the aforementioned property after this day may render this approval null and void.**

By Brian Murphy Date 03/12/2022
(Date of issue)

This is a permit to construct and is not intended to imply approval of any work proposed or completed on this lot.

Tennessee Department of Environment and Conservation - Division of Water Resources
Permit for Construction of a Subsurface Sewage Disposal System



Issued To: Dustin Moore

Location: Stevia Way

Misty Acres Lot 41

Inspector: Brian Murphy *Brian Murphy*

Date: 03/12/2022

General Notes:

- Please refer to the design specifications for the subsurface sewage disposal system on the first page of the construction permit.
- Contact the local Division of Water Resources representative to schedule a final inspection.
- All electric components (e.g., pump, alarm, etc.) for the subsurface sewage disposal system must be inspected and approved by the appropriate electrical inspector prior to requesting a final inspection. Documentation of the electrical inspection must be available during the final inspection.

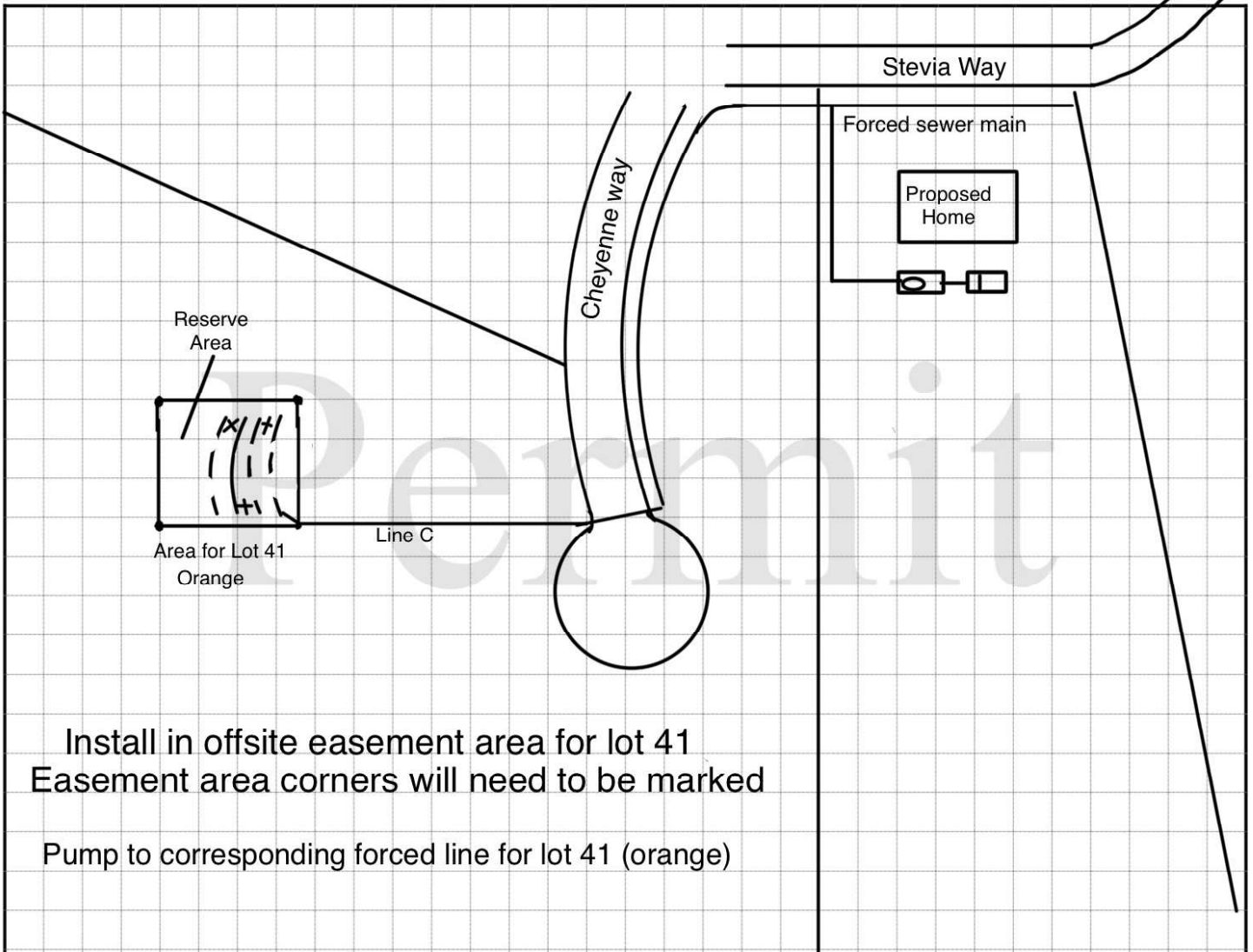

Install in offsite easement area for lot 41
Easement area corners will need to be marked

Pump to corresponding forced line for lot 41 (orange)