

Building Sketch

Borrower				
Property Address 24522 Joe May Rd				
City	Denham Springs	County	State	LA Zip Code 70726
Lender/Client				

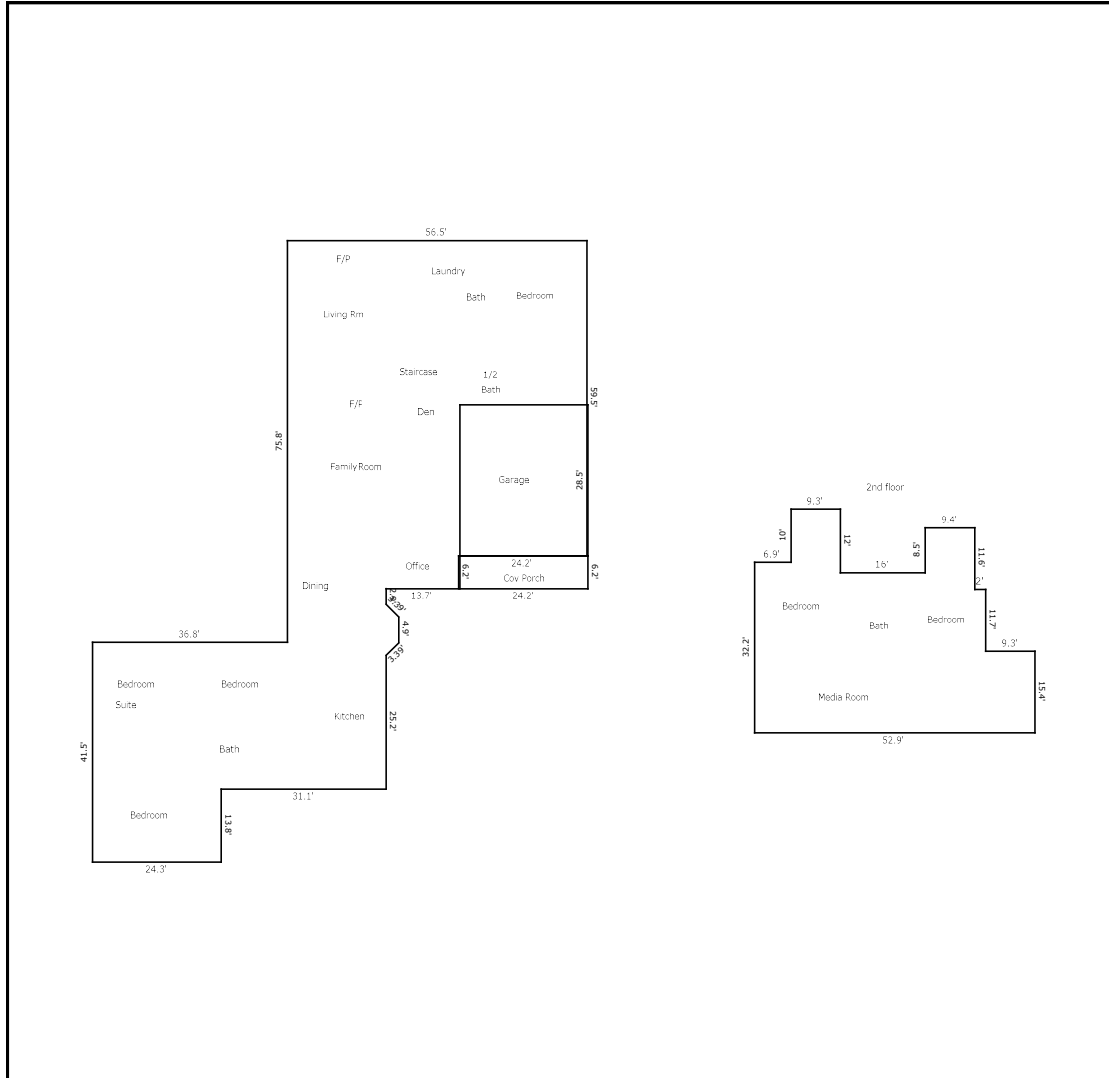

TOTAL Sketch by a la mode

Area Calculations Summary

Living Area	Calculation Details	
First Floor	5637.31 Sq ft	
		$0.5 \times 2.4 \times 2.4 = 2.88$ $0.5 \times 2.4 \times 2.4 = 2.88$ $4.9 \times 2.4 = 11.76$ $56.5 \times 59.5 = 3361.75$ $41.5 \times 24.3 = 1008.45$ $31.1 \times 27.7 = 861.47$ $16.3 \times 18.6 = 303.18$ $13.7 \times 6.2 = 84.94$
2 Car Attached	-689.7 Sq ft	$28.5 \times 24.2 = 689.7$
Second Floor	1659.04 Sq ft	
		$9.3 \times 10 = 93$ $9.4 \times 8.5 = 79.9$ $15.4 \times 9.3 = 143.22$ $43.6 \times 27.1 = 1181.56$ $5.1 \times 16.2 = 82.62$ $3.1 \times 25.4 = 78.74$
Total Living Area (Rounded):	6607 Sq ft	
Non-living Area		
Cov Porch	150.04 Sq ft	$6.2 \times 24.2 = 150.04$