

KANSAS ROUTE 152 - MARKET STREET

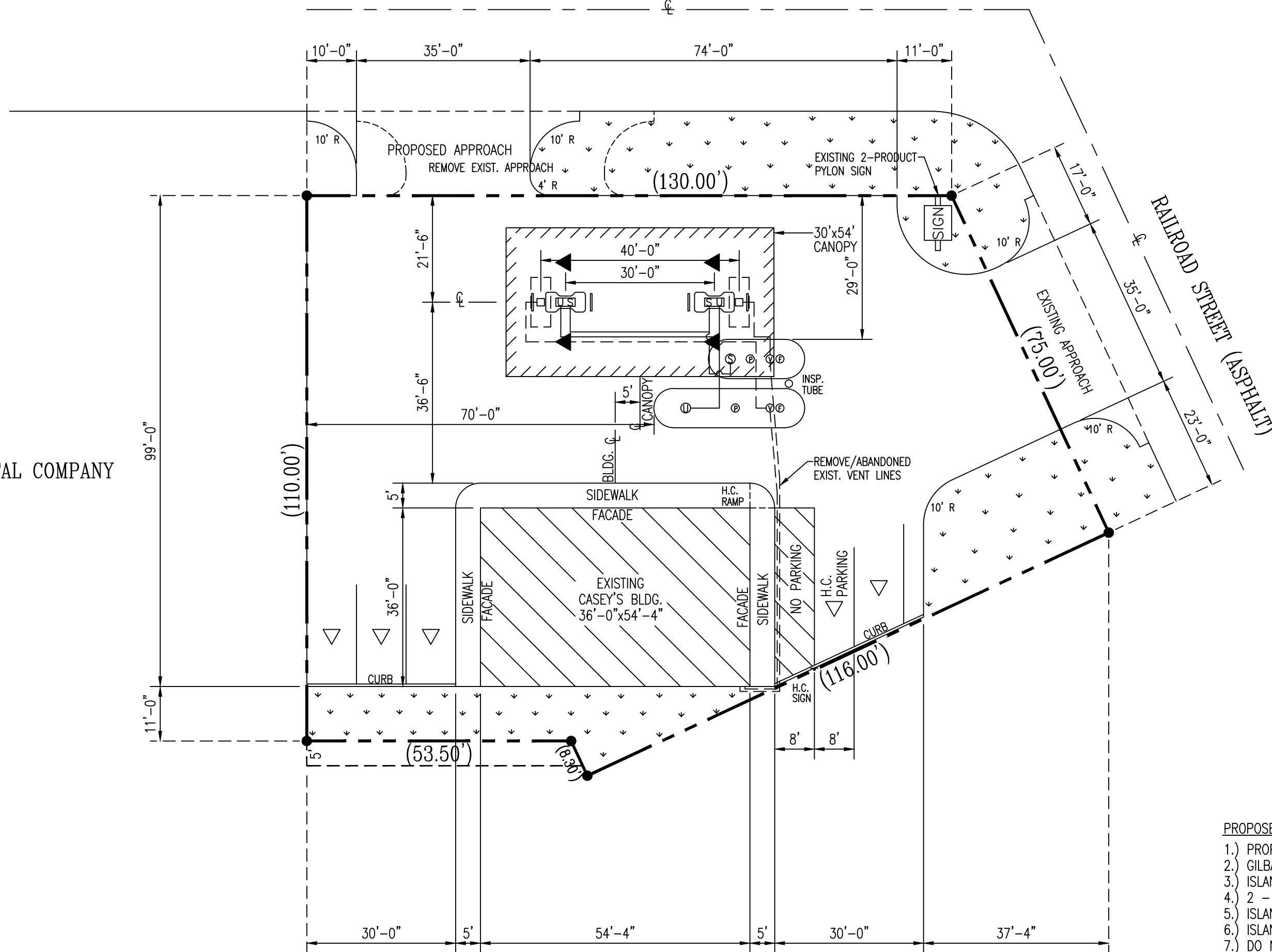

WESTERN METAL COMPANY

ORIGINAL NOTES: (COMPLETED: 05-09-86)

- 1.) 1-10,000 GALLON FIBERGLASS TANK/REGULAR 7'-11"x30'-5" (U)
- 2.) 1-6,000 GALLON FIBERGLASS TANK/UNLEADED 7'-11"x19'-5" (S)
- 3.) TANK SETTING DETAILS PAGE D8
- 4.) FILL PIPE AND MANHOLE DETAIL PAGE D8
- 5.) CIRCUIT BREAKER PANEL D4
- 6.) REFRIGERATION WIRING PAGE D5
- 7.) VEEDEROOT DETAIL PAGE D6
- 8.) ISLAND SIZE 28'
- 9.) SIX HOSE DUAL PRODUCT
- 10.) ISLAND DETAILS PAGE D8
- 11.) ISLAND CONDUIT DETAIL PAGE D4
- 12.) DO NOT PLACE PRODUCT PIPING UNDER ISLAND
- 13.) 18" MIN. FROM TANK PIPING TO FINISHED SURFACE
- 14.) SIGN BASE DETAILS PAGE D10
- 15.) SIGN DETAILS D11
- 16.) APPROACH AREA EST. SQ. FT.
- 17.) DRIVE AREA EST. SQ. FT.
- 18.) CONCRETE DRIVE TO BE MACHINE TROWELED WITH LIGHT BROOM FINISH
- 19.) CONTROL JOINTS - MIN. 100 SQ. FT. - MAX. 225 SQ. FT. - 25% DEEP
- 20.) CONSTRUCTION JOINTS - PINNED 4' O.C. 12" EACH WAY W/1/2" REBAR #4
- 21.) EXPANSION MATERIAL ON PROPERTY LINES WHERE CONCRETE MEETS CONCRETE D7
- 22.) APPROACHES TO BE 9" NONREINFORCED PAGE D7

EXISTING NOTES: (COMPLETED: 08-17-93)

- F) FILL AREA CATCH BASIN-OVERSPILL PREVENTION W/OPTIONAL DROP TUBE FLOAT-OVERFILL PREVENTION
- S-U) SUB PUMP WITH-LINE DETECTION MONITORING (FOR PRESSURE SYSTEM) OR REMOVE EXISTING ANGLE CHECK VALVE AT TANK LOCATION AND INSTALL CHECK VALVE UNDER DISPENSER AT ISLAND PER LINE (FOR SUCTION SYSTEM)
- P) TANK PROBE-TANK DETECTION MONITORING
- V) VENT EXTRACTOR W/BALL FLOAT OPTIONAL-OVERSPILL PREVENTION
- NOTE: VERIFY TANK LOCATION AND BURIAL DEPTH

PROPOSED NOTES: 04-19-01

THE EXISTING GASOLINE SYSTEM IS A SUCTION TYPE. THE IMPROVEMENTS FOR GILBARCO DISPENSERS WILL REQUIRE SUB-PUMPS TO BE INSTALLED ON THE EXISTING FIBERGLASS TANKS TO HAVE THE GASOLINE SYSTEM BE THE PRESSURE TYPE.

THE BURIAL DEPTH AND SIZE OF THE TANKS WILL NEED TO BE VERIFIED TO GET THE CORRECT SUB-PUMPS. THIS CAN BE COORDINATED BETWEEN BOTH OF YOU.

PROPOSED NOTES: 04-19-01

- 1.) PROPOSED 30'x54' CANOPY.
- 2.) GILBARCO WIRING PAGE G1.
- 3.) ISLAND SIZE - 2 DOGBONE @8" W/DUAL GUARD PIPE.
- 4.) 2 - 4 HOSE GILBARCO QUAD (ADVANTAGE) DISPENSERS.
- 5.) ISLAND DETAILS PAGE C3.
- 6.) ISLAND CONDUIT DETAIL PAGE E6.
- 7.) DO NOT PLACE PRODUCT PIPING UNDER ISLAND.
- 8.) 18" MIN. FROM TANK PIPING TO FINISH SURFACE.
- 9.) DRIVEWAY JOINTS TO BE PACKED & CAULKED.
- 10.) CONCRETE DRIVE TROWELED WITH LIGHT BROOM FINISH.
- 11.) CONTROL JOINTS - MIN. 100 SQ. FT. - MAX. 125 SQ. FT. - 25% DEEP.
- 12.) CONSTRUCTION JOINTS - PINNED 4' O.C. 12" EACH WAY WITH 1/2" REBAR #4.
- 13.) RUN VENT LINES UP SEPARATE CANOPY COLUMNS.
- 14.) VERIFY ALL UTILITY LOCATIONS.
- 15.) PROPOSED INTERCOM SYSTEM.
- 16.) FIBERGLASS PIPING (PRODUCT & VENT) WITH ENVIRON SUMPS.
- 17.) MOVE EXISTING APPROACH ON HIGHWAY TO THE WEST.
- 18.) REMOVE EXISTING ISLAND, PUMPS AND VENT LINES.

NOTE: (PROPOSED IMPROVEMENTS: TO INCLUDE THE FOLLOWING) 04-19-01

1. INSTALL H.C. PARKING SIGN
2. H.C. PARKING SPACE
3. RAMP SIDEWALK 1:20 SLOPE

LEGAL DESCRIPTION:

LOTS 4 AND 5, EXCEPT THE SOUTH 5 FEET OF LOT 4, IN BLOCK 12 AND LOTS 9, 10, 11, AND 12, IN BLOCK 5, CITY OF La CYGNE, LINN COUNTY, KANSAS, ACCORDING TO THE RECORDED PLAT THEREOF.

SITE: La CYGNE, KANSAS						REVISED			
CASEY'S CONSTRUCTION DIVISION						08-17-93			
One Convenience Blvd., P.O. Box 3001, Ankeny, Ia. 50021 515-965-6100						04-19-01			
SCALE: 1"=20'-0"		DRAWN BY: K. SCHULZE		DEPARTMENT: CONSTRUCTION DIVISION		DATE: 05-09-86		04-30-01	
DRAWING INFORMATION: PLAN "C" 36'-0" x 54'-4"						05-11-01			
						05-18-01			
						08-02-01			
						DRAWING NUMBER: PLOT			