

Building Sketch

| | | | | |
|------------------|----------------------------|---------------|----------|----------------|
| Borrower | NEFF, CLINTON | | | |
| Property Address | 7631 Baldwin Ln | | | |
| City | Taylor | County Navajo | State AZ | Zip Code 85939 |
| Lender/Client | Amerifirst Financial, Inc. | | | |

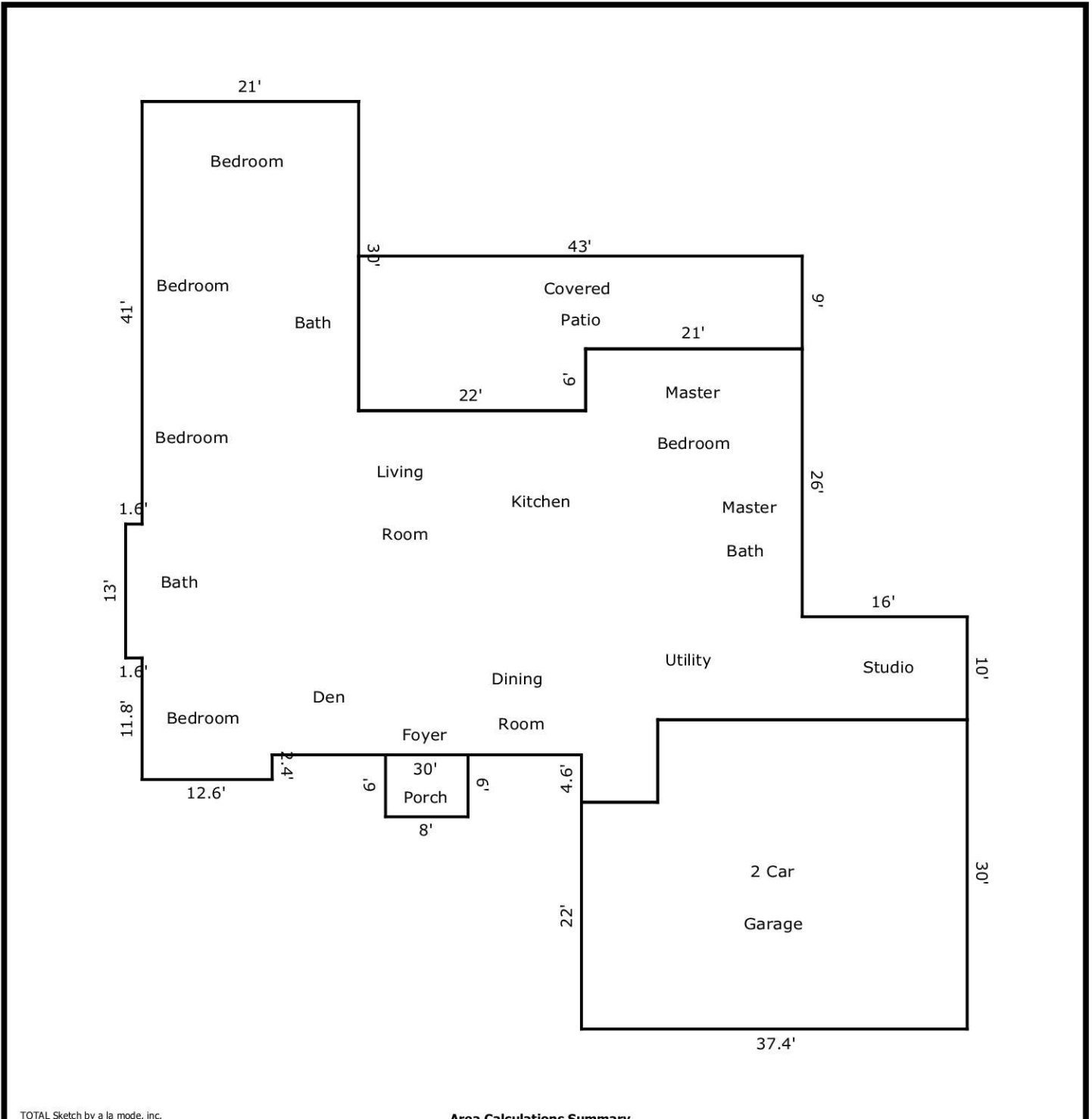

TOTAL Sketch by a la mode, inc.

Area Calculations Summary

| Living Area | Calculation Details | |
|-------------------------------------|---------------------|--|
| First Floor | 3091.08 Sq ft | $13 \times 1.6 = 20.8$ $21 \times 30 = 630$ $10 \times 16 = 160$ $7.4 \times 4.6 = 34.04$ $36 \times 14 = 504$ $7 \times 6 = 42$ $33.4 \times 37.4 = 1249.16$ $35.8 \times 12.6 = 451.08$ |
| Total Living Area (Rounded): | 3091 Sq ft | |
| Non-living Area | | |
| Covered Patio | 519 Sq ft | $15 \times 22 = 330$ $21 \times 9 = 189$ |
| Covered Porch | 48 Sq ft | $8 \times 6 = 48$ |
| 2 Car Attached | 1062.8 Sq ft | $30 \times 30 = 900$ $7.4 \times 22 = 162.8$ |