

# Soils Map

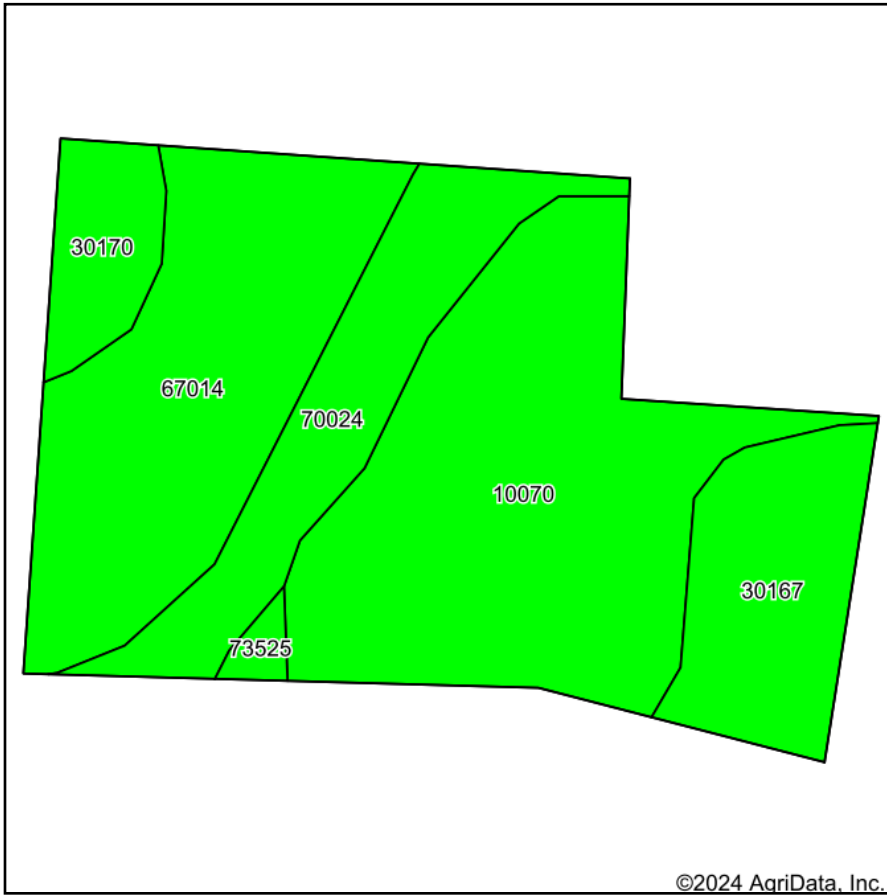

Soils data provided by USDA and NRCS.

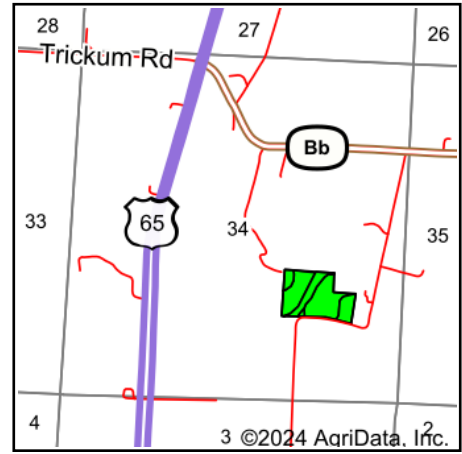

State: **Missouri**  
 County: **Pettis**  
 Location: **34-48N-21W**  
 Township: **Longwood**  
 Acres: **16.02**  
 Date: **8/2/2024**

**BigIron**  
 REALTY

Maps Provided By:  
  
 CUSTOMIZED ONLINE MAPPING  
 © AgriData, Inc. 2023 www.AgriDataInc.com



Area Symbol: MO159, Soil Area Version: 26

Code	Soil Description	Acres	Percent of field	Non-Irr Class Legend	Non-Irr Class *c	*n NCCPI Overall	*n NCCPI Corn	*n NCCPI Soybeans
10070	Ladoga silt loam, 5 to 9 percent slopes	6.11	38.2%		IIIe	65	65	56
67014	Dameron silt loam, 1 to 3 percent slopes, frequently flooded	4.39	27.4%		IIIw	72	72	60
70024	Goss very gravelly silt loam, 15 to 35 percent slopes, very stony	2.34	14.6%		Vle	12	12	3
30167	Pershing silt loam, 2 to 5 percent slopes	2.10	13.1%		IIIe	65	65	51
30170	Pershing silt loam, 5 to 9 percent slopes, eroded	0.92	5.7%		IIIe	64	64	49
73525	Blueick silt loam, 5 to 9 percent slopes	0.16	1.0%		IIIe	72	72	52
<b>Weighted Average</b>					<b>3.44</b>	<b>*n 59.2</b>	<b>*n 59.2</b>	<b>*n 48.3</b>

\*n: The aggregation method is "Weighted Average using all components"

\*c: Using Capabilities Class Dominant Condition Aggregation Method

Soils data provided by USDA and NRCS.