

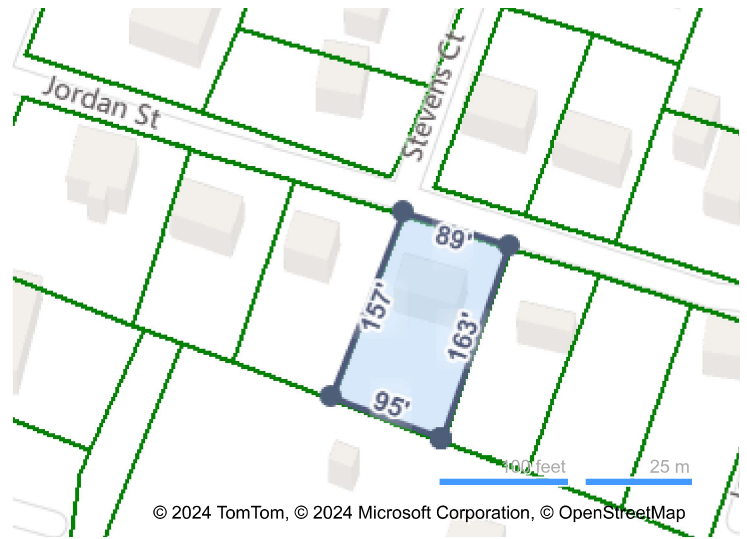

Kenneth J Pujdak  
 Broker/Owner  
 864-399-8333  
 KenP@1stClassRE.com

Thursday, July 25, 2024



© 2024 TomTom, © 2024 Microsoft Corporation, © OpenStreetMap

**LOCATION**

<b>Property Address</b>	8 Jordan St Inman, SC 29349-9403	
<b>Subdivision</b>	S A Ballew Subdivision & A	
<b>County</b>	Spartanburg County, SC	

**GENERAL PARCEL INFORMATION**

<b>Parcel ID/Tax ID</b>	1-44-11-022.00
<b>Alternate Parcel ID</b>	6176-57-3927.04
<b>Account Number</b>	
<b>District/Ward</b>	1D00
<b>2010 Census Trct/BIK</b>	229/3
<b>Assessor Roll Year</b>	2023

**PROPERTY SUMMARY**

<b>Property Type</b>	Unknown
<b>Land Use</b>	
<b>Improvement Type</b>	Other
<b>Square Feet</b>	950

**CURRENT OWNER**

<b>Name</b>	Tucker Gary M
<b>Mailing Address</b>	2539 Peniel Rd Columbus, NC 28722-6449

**SCHOOL INFORMATION**

These are the closest schools to the property

<b>Inman Elementary School</b>	0,9 mi
Elementary: Pre K to 3	Distance
<b>Inman Intermediate School</b>	1,2 mi
Primary Middle: 4 to 6	Distance
<b>T E Mabry Middle School</b>	1,2 mi
Middle: 7 to 8	Distance
<b>Chapman High School</b>	1,9 mi
High: 9 to 12	Distance

**SALES HISTORY THROUGH 07/18/2024**

Date	Amount	Buyer/Owners	Seller	Instrument	No. Parcels	Book/Page Or Document#
1/24/2023	\$82,500	Tucker Gary M				140Q/106 2023003572
12/6/2022	\$67,500	Us Trust National Association Trustee	Sauls Susan Dianne	Warranty Deed		140D/154 2022061976
10/1/1995	\$10	Sauls Susan Dianne				63V/656 19961427

**TAX ASSESSMENT**

Appraisal	Amount	Assessment	Amount
<b>Appraisal Year</b>	2023	<b>Assessment Year</b>	2023

<b>Appraised Land</b>	\$9,000	<b>Assessed Land</b>	\$445
<b>Appraised Improvements</b>	\$74,800	<b>Assessed Improvements</b>	\$3,700
<b>Total Tax Appraisal</b>	\$83,800	<b>Total Assessment</b>	\$4,145
		<b>Exempt Amount</b>	
		<b>Exempt Reason</b>	

#### TAXES

Tax Year	City Taxes	County Taxes	Total Taxes
2023		\$1,579.08	\$1,653.08
2022			\$494.80
2021			\$494.80
2020			\$483.00
2019			\$483.00
2018			\$483.00
2017			\$404.20
2016			\$404.20
2015		\$786.86	\$392.64
2014		\$387.45	\$387.45
2013		\$376.24	\$376.24

#### MORTGAGE HISTORY

Date	Loan Amount	Borrower	Lender	Book/Page or Document#
03/12/2012	\$64,206	Sauls Susan Dianne	Jp Morgan Chase Bank	4560/410 201211511
10/11/2007	\$66,600	Sauls Susan Dianne	Spartanburg Mortgage	3983/569 200755574
10/14/2004	\$43,274	Sauls Susan Deanne	Wachovia Bank	3322/78

#### PROPERTY CHARACTERISTICS: BUILDING

##### Building # 1

<b>Type</b>	Other	<b>Condition</b>	Average	<b>Units</b>	1
<b>Year Built</b>	1962	<b>Effective Year</b>		<b>Stories</b>	1
<b>BRs</b>	2	<b>Baths</b>	1 F H	<b>Rooms</b>	
<b>Total Sq. Ft.</b>	950				
<b>Building Square Feet (Living Space)</b>			<b>Building Square Feet (Other)</b>		
			Detached Garage Unfinished		
			Basement Crawl		

##### - CONSTRUCTION

<b>Quality</b>		<b>Roof Framing</b>	Gable And Hip
<b>Shape</b>		<b>Roof Cover Deck</b>	Composition Shingle
<b>Partitions</b>		<b>Cabinet Millwork</b>	
<b>Common Wall</b>		<b>Floor Finish</b>	Hardwood/Parque
<b>Foundation</b>	Block/Brick	<b>Interior Finish</b>	Drywall
<b>Floor System</b>		<b>Air Conditioning</b>	Yes/Unknown
<b>Exterior Wall</b>	Siding Average	<b>Heat Type</b>	Central
<b>Structural Framing</b>		<b>Bathroom Tile</b>	
<b>Fireplace</b>		<b>Plumbing Fixtures</b>	

##### - OTHER

<b>Occupancy</b>	<b>Building Data Source</b>
------------------	-----------------------------

#### PROPERTY CHARACTERISTICS: EXTRA FEATURES

No extra features were found for this parcel.

#### PROPERTY CHARACTERISTICS: LOT

Land Use		Lot Dimensions	
Block/Lot	/58	Lot Square Feet	14,810
Latitude/Longitude	35.038599°/-82.084527°	Acreage	0.34

#### PROPERTY CHARACTERISTICS: UTILITIES/AREA

Gas Source		Road Type	Paved
Electric Source		Topography	Level
Water Source	Public	District Trend	
Sewer Source	Public	Special School District 1	
Zoning Code		Special School District 2	
Owner Type			

#### LEGAL DESCRIPTION

Subdivision	S A Ballew Subdivision & A	Plat Book/Page	
Block/Lot	/58	District/Ward	1D00
Description	Lot 58 S A Ballew Subdivision & Adj Lot Pb 24-428 Pb 101-873 Jr# 126818 & Db 72C-665 /Fire District: lcf		

#### INTERNET ACCESS

courtesy of Fiberhomes.com

Provider	Type	Confirmed	Advertised Top Download Speed	Advertised Top Upload Speed
Windstream	FIBER	No	1000 Mbps	
Spectrum	CABLE	No	1000 Mbps	
Windstream	DSL	No	200 Mbps	

#### FEMA FLOOD ZONES

Zone Code	Flood Risk	BFE	Description	FIRM Panel ID	FIRM Panel Eff. Date
X	Minimal		Area of minimal flood hazard, usually depicted on FIRMs as above the 500-year flood level.	45083C0140D	01/06/2011

#### LISTING ARCHIVE

MLS #	Status	Status Change Date	List Date	List Price	Closing Date	Closing Price	Listing Agent	Listing Broker	Buyer Agent	Buyer Broker
1510668	Sold	11/28/2023	10/13/2023	\$199,999	11/28/2023	\$189,500	Kimberly J Karaman	Town & Country Realty Carolina	Kimberly J Karaman	Town & Country Realty Carolina