

# LENNAR

# Residence 1815



## Elevation A



## Elevation B



## Elevation C

This new single-story home provides ample space for the whole family to thrive. The Great Room extends effortlessly to the dining room and multi-functional kitchen in an open-plan layout. The covered porch makes indoor-outdoor entertaining a breeze. Four bedrooms including a spacious owner's suite with a luxe bathroom and large walk-in closet offer restful nights and tranquility.

1,815  
Square ft.

4  
Beds

2  
Baths

2  
Car Garage

LennarCoastalAlabama.com  
334.679.3633  
9010 Alabatross Drive  
Foley, AL36535



Scan for more information

# LENNAR

# Residence 1815

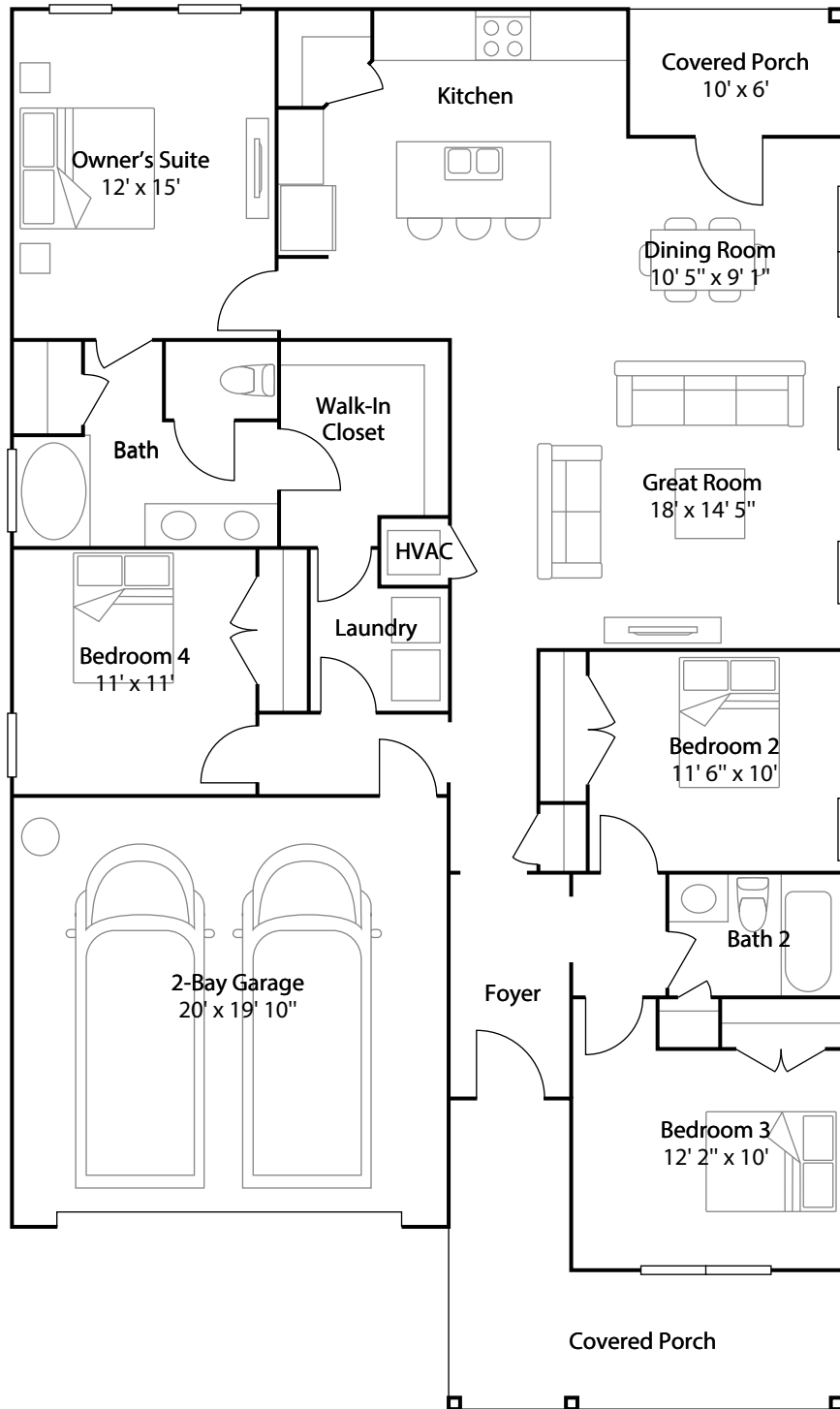

Plans and elevations are artist's renderings and may contain options which are not standard on all models. Ceiling type may vary with elevation. Lennar reserves the right to make changes to these floor plans, specifications, dimensions and elevations without prior notice. Stated dimensions and square footage are approximate and should not be used as representation of the home's precise or actual size. Any statement, verbal or written, regarding "under air" or "finished area" or any other description or modifier of the square footage size of any home is a shorthand description of the manner in which the square footage was estimated and should not be construed to indicate certainty. Subject to errors and omissions. Copyright© 2022 Lennar Corporation. Lennar and the Lennar logo are registered service marks of Lennar Corporation and/or its subsidiaries.

