

# HOME FOR SALE

**PRICE REDUCED!**



Virtual Tour  
Available Online!



## South Bertrand Acreage

4 ± ACRES | PHELPS COUNTY, NEBRASKA

### Small Lifestyle Acreage

Offers endless opportunities for hobbies and outdoor living. Its location offers the perfect blend of rural privacy and accessibility, situated near Holdrege and Kearney, NE.

#### LISTING AGENTS:



Dan Muirhead



Faith Correll

#### DAN MUIRHEAD

C: 308.325.4538 | E: DMuirhead@AgriAffiliates.com

#### FAITH CORRELL

C: 308.386.8035 | E: FCorrell@AgriAffiliates.com

*D.J. Lunkwitz, Chase Dodson, Bruce Dodson, Kent Richter, Bryan Danburg, Bonnie Downing, Mike Wilken, Bart Woodward*

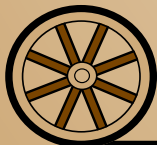

Offered exclusively by:

**AGRI AFFILIATES, INC.**  
Providing Farm & Ranch Real Estate Services

North Platte, NE • **AgriAffiliates.com** • 308.534.9240

Information contained herein was obtained from sources deemed reliable. We have no reason to doubt the accuracy, but the information is not guaranteed. Prospective Buyers should verify all information. All maps provided by Agri Affiliates, Inc. are approximations only, to be used as a general guideline, and not intended as survey accurate. As with any agricultural land, this property may include noxious weeds. Agri Affiliates, Inc. and all agents are acting as Agent of the Seller.

## PROPERTY INFORMATION

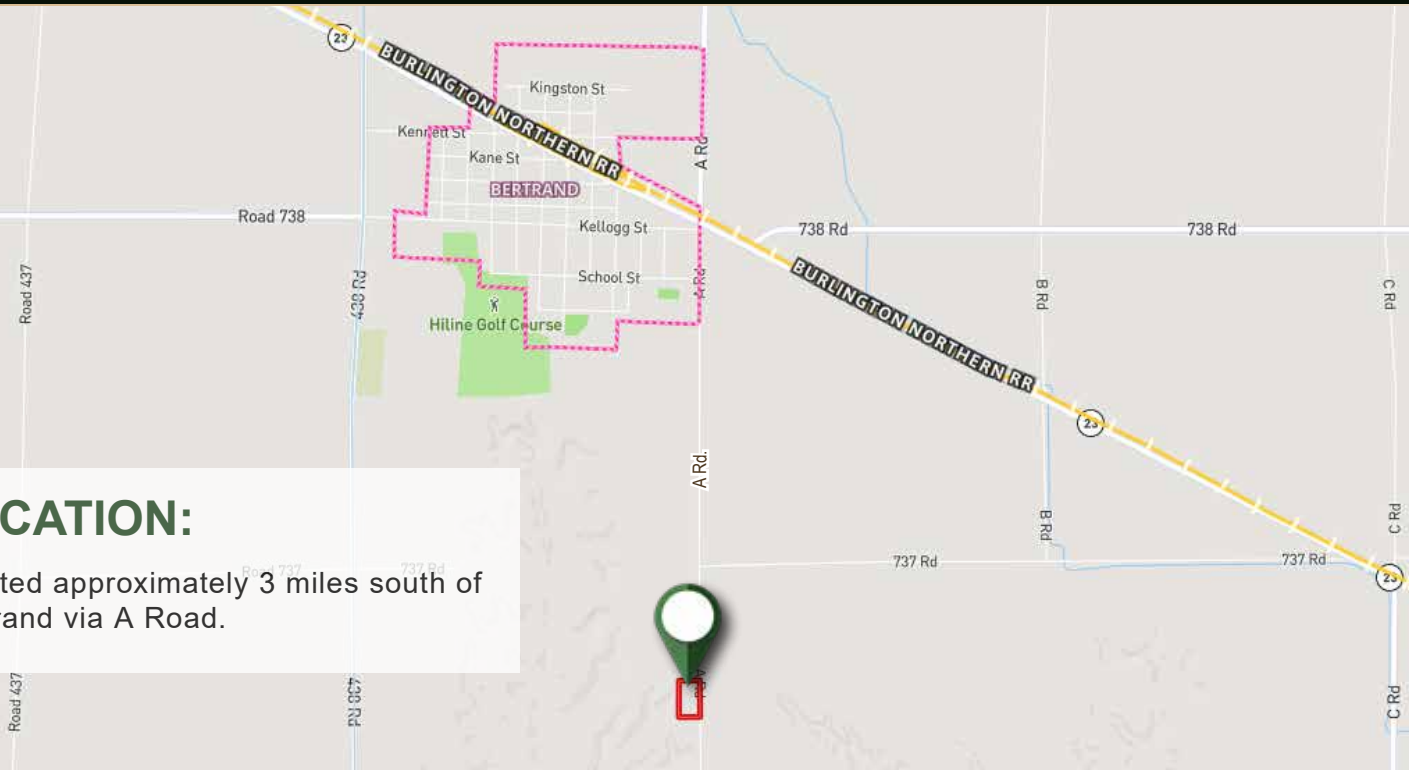

### LOCATION:

Located approximately 3 miles south of Bertrand via A Road.

**LEGAL DESCRIPTION:** PT. NE¼ 7-6-20 UNION, West of the 6th P.M. in Phelps County, Nebraska.

**ADDRESS:** 73647 A Rd.  
Bertrand, NE 68927

**TAXES & ACRES:** 4.155 Tax-Assessed Acres  
2023 Real Estate Taxes due in 2024: \$4,406.22

**HOUSE INFORMATION:**

- Split-level home, built in 1978. Assessor reports 2,584 sq. ft. with 840 sq. ft. basement area.
- 1 Bedroom/2 Bathroom upstairs; 2 Bonus Rooms/1 Bathroom downstairs.
- Refrigerator, stove, dishwasher, microwave, and Generac generator included.
- 528 sq. ft. attached 2-car garage, with separate attached office area.

**OUTBUILDING INFORMATION:**

- 2,700 sq. ft. Cleary insulated and heated shop building with concrete floor, electric, water, & office.
- 2,024 sq. ft. freestall rustic barn.
- Numerous small sheds/lean-to buildings.

**OTHER INFORMATION:** Propane tanks are leased and do not sell with the property.

**PRICE REDUCED!**

**PRICE:** ~~\$495,000~~ **\$475,000**



## PROPERTY IMAGES

Virtual Tour  
Available Online!



Showing by Appointment Only!



# 73647 A Road, Bertrand



*Spacious, Split-level Home*  
with attached 2-car garage, shop, & barn.







**SHOP BUILDING**

2,700 sq. ft. Cleary "Mechanics Dream" shop building. Insulated & heated with concrete floor, water, electric & office.

*Small acreage, with well-established tree's.*



**RUSTIC BARN**

2,024 sq. ft. freestall wood barn.

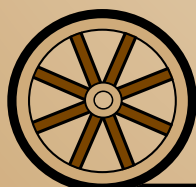

**AGRI AFFILIATES, INC.**  
*Providing Farm & Ranch Real Estate Services*

North Platte, NE • [AgriAffiliates.com](http://AgriAffiliates.com) • 308.534.9240