



**TENNESSEE DEPARTMENT OF ENVIRONMENT AND CONSERVATION  
APPLICATION FOR GROUND WATER PROTECTION SERVICES**

1. SERVICE REQUESTED: (check service)	APPLICANT COMPLETE QUESTIONS:	FEES DUE	PTBMIS CODES V689 Code Supp/Code	
<input checked="" type="checkbox"/> Septic System Construction Permit				
<input checked="" type="checkbox"/> Dwelling .....	2, 3, 4, 7, 8, 9	\$ <u>200.00</u>	78064	Yes
Commercial: gpd .....	2, 3, 4, 7, 8, 9	\$ _____	78064	Yes
System Modification .....	2, 3, 4, 7, 8, 9	\$ _____	78064	Yes
Repair .....	2, 3, 4, 7, 8, 9	\$ _____	78032	
Inspection Letter .....	2, 3, 5, 7, 8, 9	\$ _____	78030	
Water Sample				
Total Coliform .....	2, 3, 6, 7, 8, 9	\$ _____	78036	Yes
Fecal Coliform .....	2, 3, 6, 7, 8, 9	\$ _____	78038	Yes
Alternative System Permit* .....		\$ _____	78068	
Large Conventional System Plan Review* .....		\$ _____	78090	
Large Alternative System Plan Review* .....		\$ _____	78090	
Experimental System Plan Review* .....		\$ _____	78072	
Subdivision Evaluation: Lots: _____*		\$ _____	78084	
Soil Mapping: Type _____ Acres _____*		\$ _____		Yes
Installer Permit: Type(s) _____*		\$ _____	78026	Yes
Pumper Permit* .....		\$ _____	78028	
Plat Approval — Individual Lot.....		\$ _____	78029	
Domestic Septage Disposal Site Permit .....		\$ _____	78031	

\*Applicant may review these service requests with Environmental Specialist prior to processing application.

2. **LANDOWNER:** Richard + Libby Seguin **APPLICANT** Name: \_\_\_\_\_  
 Names: \_\_\_\_\_ Address: \_\_\_\_\_  
570 Tom Welch Rd Address: \_\_\_\_\_  
Crossville, Tn. 38571 Day Phone: \_\_\_\_\_  
931-484-6104 Day Phone: \_\_\_\_\_

**ORIGINAL OWNER** Name: \_\_\_\_\_

3. **LOCATION OF LOT OR SITE:** a) In a subdivision?  b) Name: Welch Acres Lot # 6  
 b) Non-Subdivision \_\_\_\_\_ Give specific directions and address to the lot or site: \_\_\_\_\_

4. **FOR SSDS PERMIT ONLY:** a) Size of lot 200' x 200' b) Number of Bedrooms 3  
 c) How many occupants? 2 d) Excavated Basement? Yes \_\_\_\_\_ No   
 e) Basement Plumbing Fixtures? Yes \_\_\_\_\_ No   
 f) Amount of water used monthly (gallons) \_\_\_\_\_  
 g) Water Supply: Public  Well \_\_\_\_\_ Spring \_\_\_\_\_  
 h) Is the lot staked?  If not, date it will be staked: \_\_\_\_\_  
 Is the house staked? NO If not, date it will be staked: ~~\_\_\_\_\_~~ STAKED 5 SEPT 2002  
 i) Installer, if known: \_\_\_\_\_

5. **FOR INSPECTION LETTER ONLY:** Will pick up \_\_\_\_\_ Please mail \_\_\_\_\_  
 a) Age of house \_\_\_\_\_ b) Is house vacant? \_\_\_\_\_ How long? \_\_\_\_\_  
 c) Original sewage system inspected \_\_\_\_\_  
 d) Date of previous repairs \_\_\_\_\_ Inspected \_\_\_\_\_  
 e) Is waste water "backing up" into plumbing fixtures? \_\_\_\_\_ Surfacing on the ground? \_\_\_\_\_  
 f) All waste water including washing machines routed into septic tank \_\_\_\_\_

6. **FOR WATER SAMPLE ONLY:** a) Source of Supply: Spring \_\_\_\_\_ Well \_\_\_\_\_  
 b) Is there an outside faucet? \_\_\_\_\_ c) Is the source chlorinated? \_\_\_\_\_  
 d) For Wells: Is the casing 6" above the ground? \_\_\_\_\_ Is a sanitary seal on the casing? \_\_\_\_\_

7. MAKE A ROUGH SKETCH ON BACK OF THIS **WHITE** PAGE SHOWING DIRECTIONS TO PROPERTY, PROPERTY LINES, HOUSE SITE, WELL LOCATION, SPRING LOCATION, PLANNED DRIVEWAY AND UTILITIES.

8. ALL FEES DUE IN ADVANCE AND ARE NON-REFUNDABLE (except upon appeal). See Fee Schedule on reverse. Make check payable to: **TREASURER, STATE OF TENNESSEE**

9. I certify that the above information is true and correct to the best of my knowledge, and that I have been authorized by the above named landowner to submit this Application for Environmental Services to the Division of Ground Water Protection.

DATE: 9-4-02 SIGNATURE: Richard E. Seguin AMOUNT PAID: \$ 200.00 RECEIPT NUMBER 292399  
 White: File Canary: Owner CR, 513  
VE

## FEE SCHEDULE

PTBMIS  
SUPP/CODE

Evaluation for Conventional, LDGP or Chamber Septic System Permit	\$200.00 up to 1000 gpd  \$100.00 for each additional 1000 gpd or portion thereof	78066
Repair	\$None	
Inspection Letter	\$200.00	
Subdivision Evaluation	\$ 40.00 per lot	
Water Samples:		
Total Coliform	\$ 50.00	78036P
Fecal Coliform	\$ 100.00	78036P
Soil Mapping:		
General Intensity	\$ 80.00 per acre — \$ 80.00 minimum	78078
High Intensity	\$130.00 per acre — \$130.00 minimum	78040
Extra High Intensity	\$200.00 per acre — \$200.00 minimum	78042
(Minimum is for each separate acre or part of acre to be mapped)		
Alternative System Application Processing	\$300.00 up to 1000 gpd \$150.00 for each additional 1000 gpm or portion thereof	78071 78070
Large Conventional or Large Alternative Plan Review	\$600.00 per proposed system	
Experimental System Application Processing	\$500.00	
Pumper Permit	\$200.00	
Installer Permit	\$200.00 for conventional, LDGP and chamber \$100.00 for each alternative system	78080
Plat Approval — Individual Lots	\$ 40.00 per lot	78029
Domestic Septage Disposal Site Permit	\$400.00	78031

### SKETCH

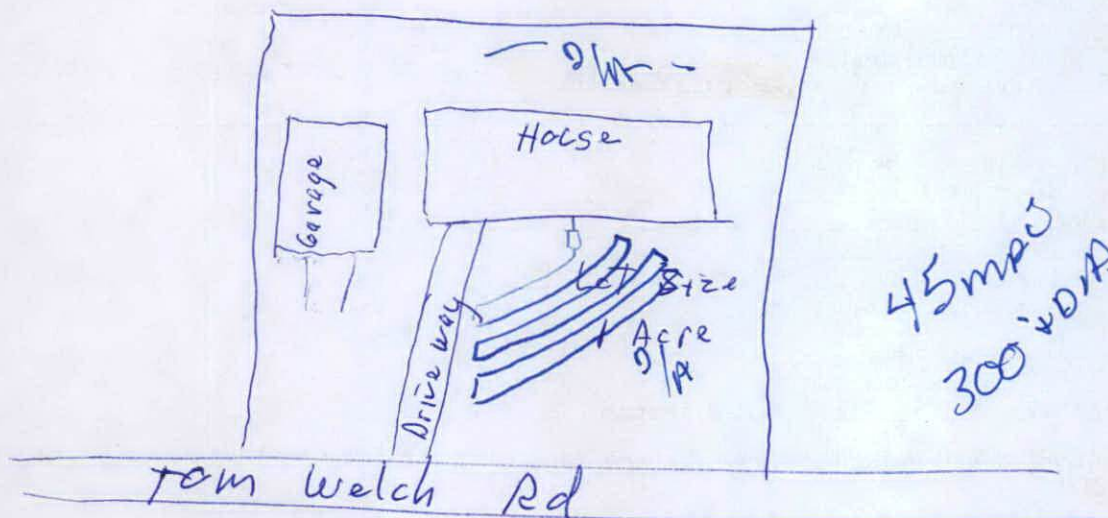

**Official Use:**

File Search

Absorption Rate \_\_\_\_\_ At Depth \_\_\_\_\_

Percolation Rate \_\_\_\_\_ At Depth \_\_\_\_\_

Other Requirements

**TENNESSEE DEPARTMENT OF ENVIRONMENT AND CONSERVATION  
DIVISION OF GROUND WATER PROTECTION  
PERMIT FOR CONSTRUCTION OF SUBSURFACE SEWAGE DISPOSAL SYSTEM**

Issued to: <u>SEQUIN, RICHARD + LIBBY</u> Owner, Developer, Contractor, Installer, Etc. Location: <u>LOT 6 WELCH ACRES</u> <u>570 TOM WELCH ROAD</u>	Evaluation Based Upon: <input checked="" type="checkbox"/> 1. Soil typing by Soil Scientist <input type="checkbox"/> a. General <input checked="" type="checkbox"/> b. High Intensity <input type="checkbox"/> c. Extra High Intensity <input type="checkbox"/> 2. Soil Percolation Test <input type="checkbox"/> 3. Environmental Specialist Estimated Absorption Rate: <u>45</u> MPI	Type of System: <input checked="" type="checkbox"/> 1. Conventional <span style="float:right">OR</span> <input type="checkbox"/> 2. Low Pressure Pipe <input type="checkbox"/> 3. Mound <input type="checkbox"/> 4. Lagoon <input checked="" type="checkbox"/> 5. Large Diameter Gravelless Pipe <span style="float:right">10"</span> <input type="checkbox"/> a. Sand backfill required <input type="checkbox"/> 6. Other
Installation: <input checked="" type="checkbox"/> 1. New Installation <input type="checkbox"/> 2. Repair to Existing System Establishment: <input checked="" type="checkbox"/> 1. Residential: # Bedrooms <u>3</u> <input type="checkbox"/> 2. Other: _____ (specify) Gal/Day _____	Approval based upon: Statute No. <u>T.C.A. 68-221-403</u> <input type="checkbox"/> (c) Percolation test <input type="checkbox"/> (d) Grandfather clause. Current standards except those specified <input checked="" type="checkbox"/> (f) 12" (karst) and 6" (non-karst) buffer required <input type="checkbox"/> (i) 9" buffer required (24"-36" total soil depth) <input type="checkbox"/> (k) Grandfather clause — meets June 30, 1990 standards (repair only) <input type="checkbox"/> Other _____	

This system shall consist of a two compartment septic tank holding 900 MIN gallons, with 300 linear feet in 5± trenches, 36 inches 18"-24" wide and 24\* inches deep. (Depth of gravel: 12 inches)  
\* DO NOT EXCEED 24" TRENCH DEPTH

Also required:  
 1. Soil Improvement Practice (SIP)  
 2. Flow Diversion Valve  
 3. Sewage Pump  
 4. Other: \_\_\_\_\_

All installers of subsurface sewage disposal systems must hold a valid annual license from the Tennessee Department of Environment and Conservation.  
 The recipient of this permit agrees to construct or have constructed the above described system in accordance with T.C.A. 68-221-401 et. seq. and The Regulations To Govern Subsurface Sewage Disposal Systems. If any part of the system is covered before being inspected and approved, it shall be uncovered by the recipient of the permit at the direction of personnel of the Department of Environment and Conservation. **Any cutting, filling or alterations of the soil conditions on the aforementioned property after this day may render this approval null and void.**

X Richard & Libby REC# 292399 Date 9-6-02  
 (Signature of Recipient)  
 Issued at CROSSVILLE Tennessee, in CUMBERLAND County  
 By Brian Houston E.S.IV Date 6 SEPT 2002  
 (Name and Title) (Date of Issue)

This permit is valid for 3 years from date of issue.

(NOT TO SCALE)

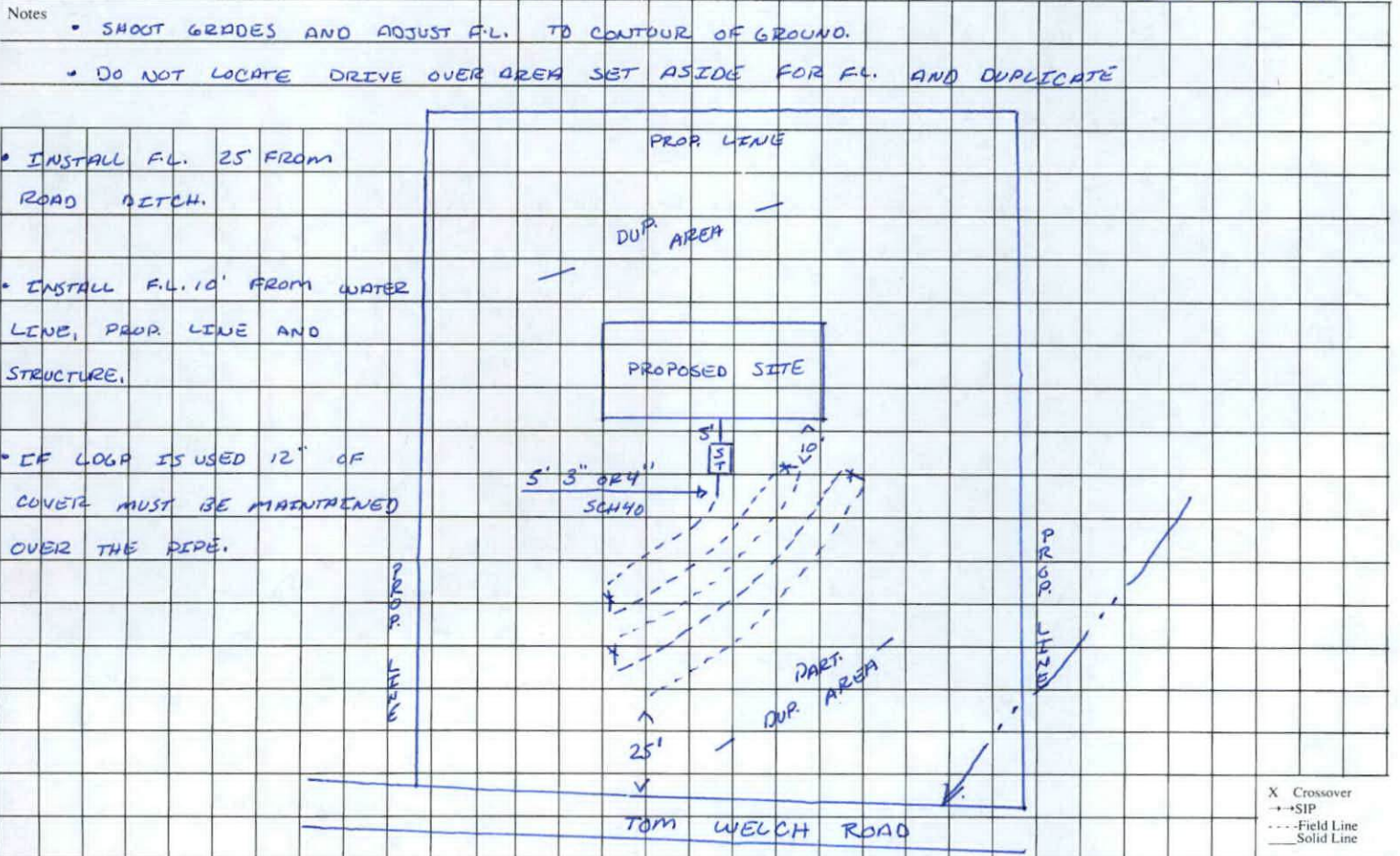

This is a permit to construct and is not intended to imply approval of any work proposed or completed on this lot.



**CERTIFICATE OF COMPLETION OF SUBSURFACE SEWAGE DISPOSAL SYSTEM**

Issued to: SEGUIN, RICHARD + LEBBY  
 Owner, Developer, Contractor, Installer, Etc.  
 Location: LOT 6 WELCH ACRES  
570 TOM WELCH ROAD

Type of system  
 1. Conventional  
 2. Low Pressure Pipe  
 3. Mound  
 4. Lagoon  
 5. Large Diameter Gravelless Pipe  
 (a) Sand backfill required Yes ( ) No ( )  
 6. Other \_\_\_\_\_  
TABS 1000 LOW BOY Septic Tank  
 (type) (volume)  
 Estimated Absorption Rate 45  
 (minutes per inch)  
 New Installation ( ) Repair ( ) Other  
 Installed by: DONNIE MAYNARD EXCAVATING.

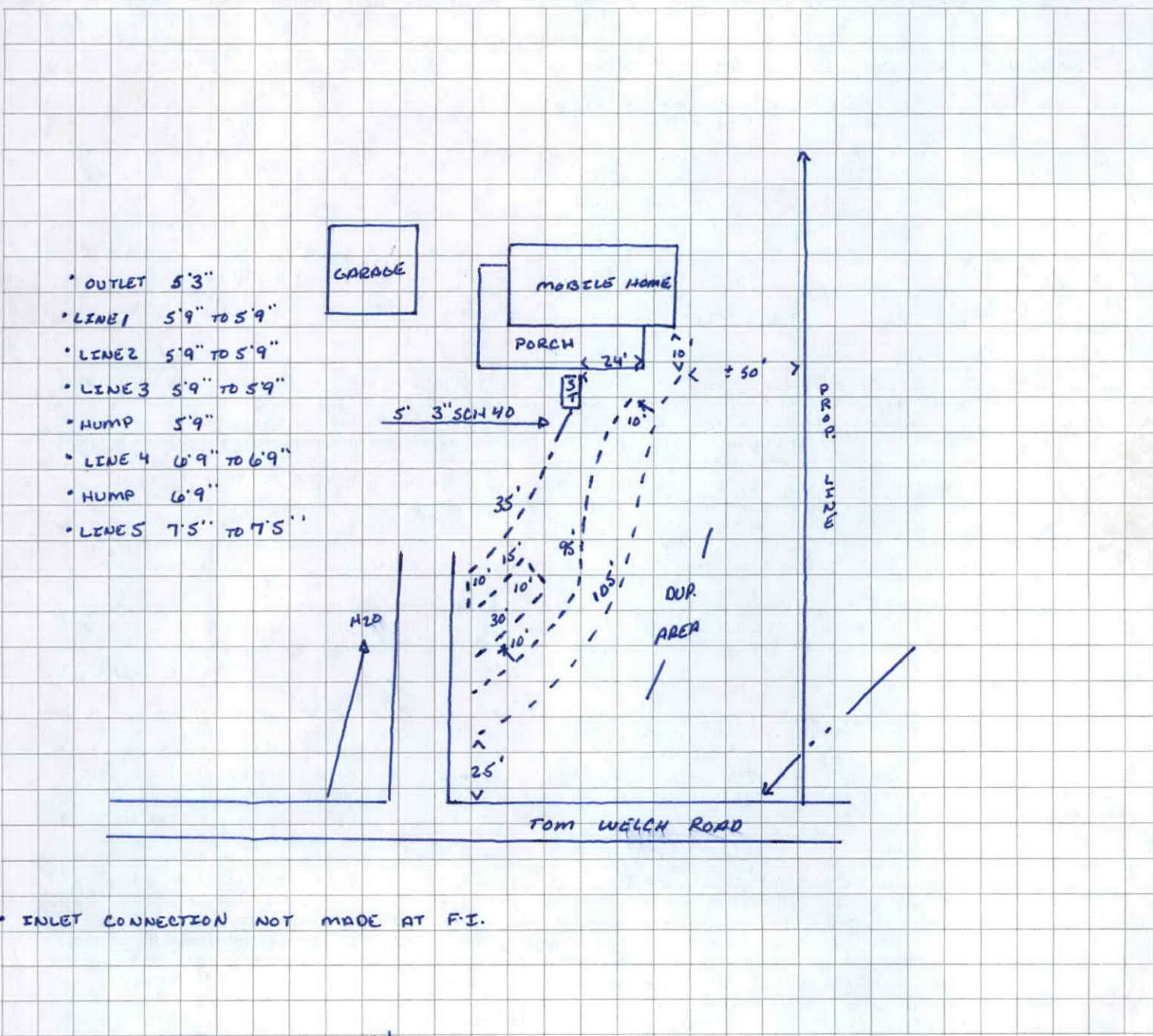

• INLET CONNECTION NOT MADE AT F.I.

Construction Approved By: Brian Houston  
 (Name and Title)

E.S. IV 25 NOV 2002  
 (date)

ANY CUTTING OR FILLING  
MAY RENDER THE DISPOSAL  
AREA UNSUITABLE

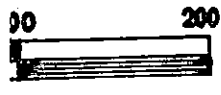

2" WATER LINE

CANYONAH ROAD

N 11°25'20" E  
39.01'

S 80°59'56" E  
212.25'

Lily  
0-15%  
45 Mpl  
30' to Rock

N 15°17'21" E  
75.82'

N 18°09'36" E  
271.12'

N 23°00'18" E  
13.85'

N 23°00'18" E  
83.24'

7  
Jefferson  
0-5%  
Mpl

Lily  
0-5%  
45 Mpl  
30' to Rock

6  
0.97 AC.

N 25°10'56" E  
116.56'

S 71°11'19" E  
213.03'

N 25°10'56" E  
62.02'

Lily  
5-15%  
45 Mpl  
30' to Rock

5  
1.06 AC.

50' R.O.W.

ING  
OSA

ANY CUTTING OR FILLING  
MAY RENDER THE DISPOSAL  
AREA UNSUITABLE

KATHRYN  
FLETCHER  
1012/1222

S 66°37'36" E  
231.00'

N 24°18'02" E  
162.20'

ROAD

Lily  
0-5%  
45 Mpl  
30' to Rock

4  
1.32 AC.

WELCH ROAD

N 24°18'02" E  
162.20'

S 65°51'23" E  
349.98'

POWER LINE  
75' R.O.W.

3  
1.32 AC.

TOM WELCH ROAD

N 24°18'02" E  
162.18'