



REEDY
LAND CO.

Gibson Ridge Farms

±5.22-10.43 Acre Homesites in Easley, SC

Parcel Overview

00 Hood Rd | Easley, SC

Pickens County Tax ID: 5111-00-75-0845

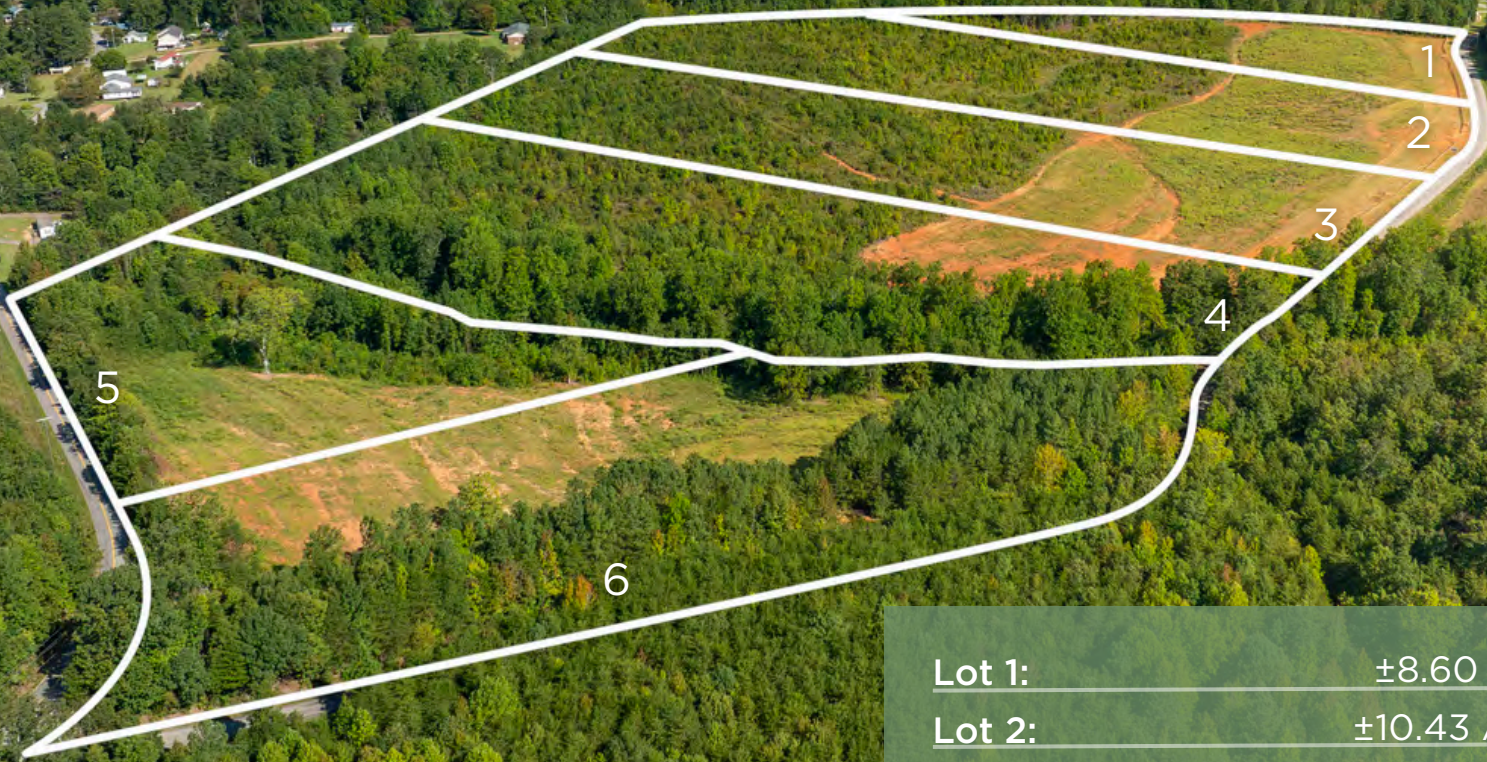

Lot 1:	±8.60 Acres \$255,000
Lot 2:	±10.43 Acres \$300,000
Lot 3:	±10.07 Acres \$300,000
Lot 4:	±10.40 Acres \$300,000
Lot 5:	±5.22 Acres \$175,000
Lot 6:	±7.32 Acres \$195,000

Executive Summary

00 Hood Rd | Easley, SC

Property & Location Highlights

- Gentle topography
- Cleared
- Mountain views
- ±8 minutes to Easley
- ±10 minutes to Pickens
- ±20 minutes to Downtown Greenville
- ±25 minutes to Lake Keowee



Offering Summary

Lot 1:	<u>±8.60 Acres \$255,000</u>
Lot 2:	<u>±10.43 Acres \$300,000</u>
Lot 3:	<u>±10.07 Acres \$300,000</u>
Lot 4:	<u>±10.40 Acres \$300,000</u>
Lot 5:	<u>±5.22 Acres \$175,000</u>
Lot 6:	<u>±7.32 Acres \$195,000</u>

Acreage, taxes, utilities and lot dimensions to be verified by Buyer and/or Buyer's agent



Property Photos



Local Amenities & Retailers

Easley, SC



Contact Information

Reedy Land Co

REEDY

Logan Mitchell

843.801.5309

lmitchell@reedypg.com

Tyler Whims

864.430.4507

twhims@reedypg.com

Tripp Taylor

336.260.5523

ttaylor@reedypg.com

