

Soils Map

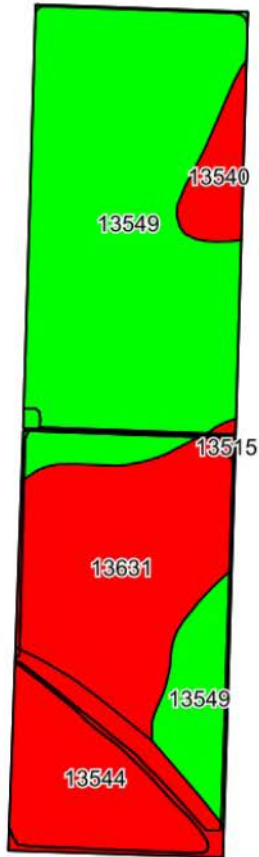

©2025 AgriData, Inc.

Soils data provided by USDA and NRCS.

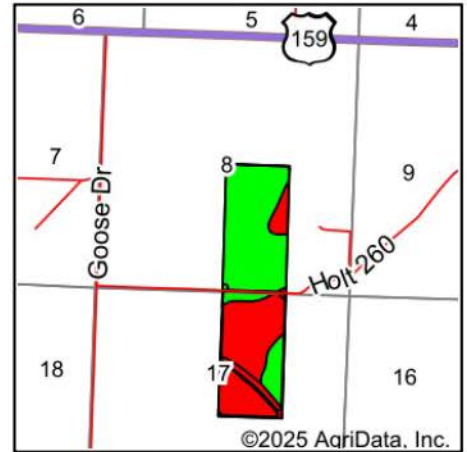

©2025 AgriData, Inc.

State: **Missouri**
 County: **Holt**
 Location: **8-60N-39W**
 Township: **Minton**
 Acres: **160.78**
 Date: **12/3/2025**

BigIron
 REALTY

Maps Provided By:



© AgriData, Inc. 2025

www.AgriDataInc.com



Area Symbol: MO087, Soil Area Version: 29

Code	Soil Description	Acres	Percent of field	Non-Irr Class Legend	Non-Irr Class *c	Irr Class *c	*n NCCPI Soybeans	
13549	Luton clay, 0 to 2 percent slopes, rarely flooded	89.14	55.4%		IVw		44	
13631	Haynie silt loam, deep loess, 0 to 2 percent slopes, rarely flooded	39.49	24.6%		Is	Is	80	
13544	Leta silty clay, 0 to 2 percent slopes, rarely flooded	25.30	15.7%		IIw		65	
13540	Blencoe silty clay, 0 to 2 percent slopes, rarely flooded	6.27	3.9%		IIw		59	
13515	Dupo silt loam, 0 to 2 percent slopes, rarely flooded	0.58	0.4%		IIw		80	
Weighted Average						2.86	*-	*n 56.9

*n: The aggregation method is "Weighted Average using all components"

*c: Using Capabilities Class Dominant Condition Aggregation Method

*- Irr Class weighted average cannot be calculated on the current soils data due to missing data.