

Building Sketch (Page - 1)

Borrower/Client	Alice and Jeffrey Jewell		
Property Address	1165 Turtle Trl		
City	New Braunfels	County	Comal
	State	TX	Zip Code 78130
Lender	First Commercial Bank		

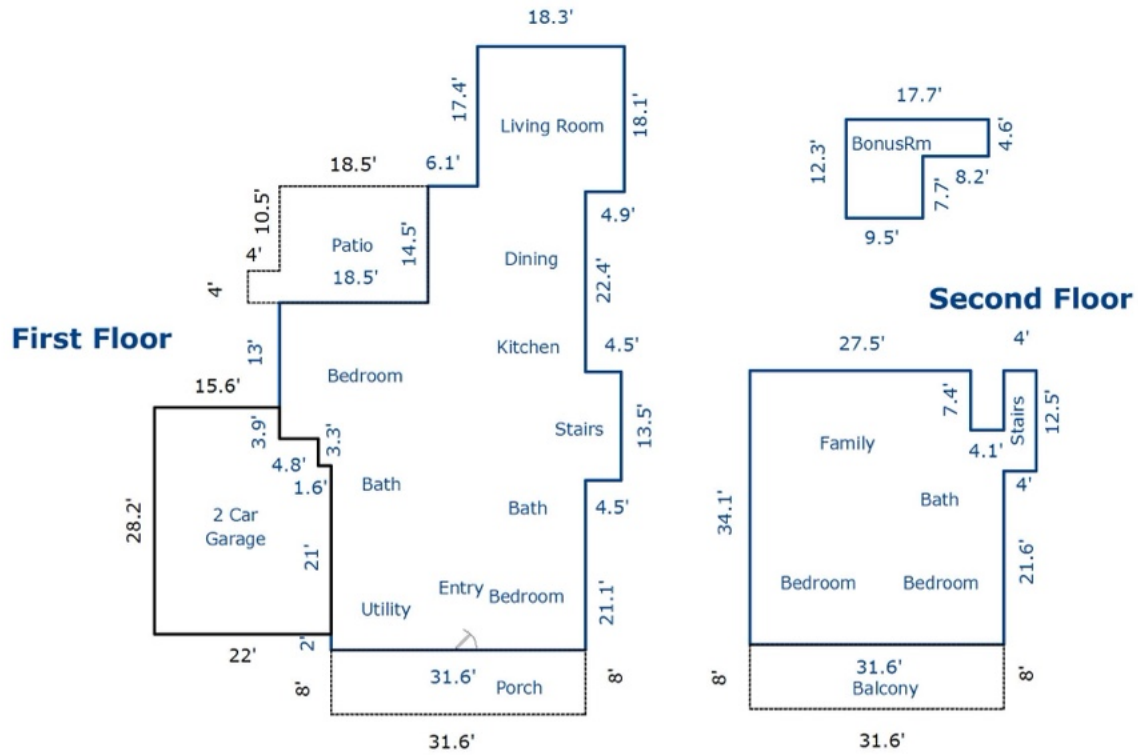

Sketch by Apex Sketch v5 Standard™

Comments:

AREA CALCULATIONS SUMMARY			
Code	Description	Net Size	Net Totals
GLA1	First Floor	2143.91	
	Second Floor	1097.22	
	Bonus Room	154.57	3395.70
GAR	Garage	590.16	590.16
P/P	Porch	252.80	
	Patio	284.25	
	Balcony	252.80	789.85
Net LIVABLE Area		(rounded)	3396

LIVING AREA BREAKDOWN			
	Breakdown		Subtotals
First Floor			
	37.7 x 3.3		124.41
	1.9 x 36.1		68.59
	8.6 x 38.0		326.80
	8.3 x 42.5		352.75
	21.1 x 31.6		666.76
	24.4 x 0.7		17.08
	13.8 x 19.5		269.10
	17.4 x 18.3		318.42
Second Floor			
	31.6 x 21.6		682.56
	35.6 x 5.1		181.56
	7.4 x 4.0		29.60
	7.4 x 27.5		203.50
Bonus Room			
	9.5 x 7.7		73.15
	17.7 x 4.6		81.42
14 Items		(rounded)	3396

Building Sketch (Page - 1)

Borrower	Jewell Jeff & Jewell Alice				
Property Address	1165 Turtle Trl				
City	New Braunfels	County	Comal	State	TX
				Zip Code	78130
Lender	Fairway Independent Mortgage Corporation				

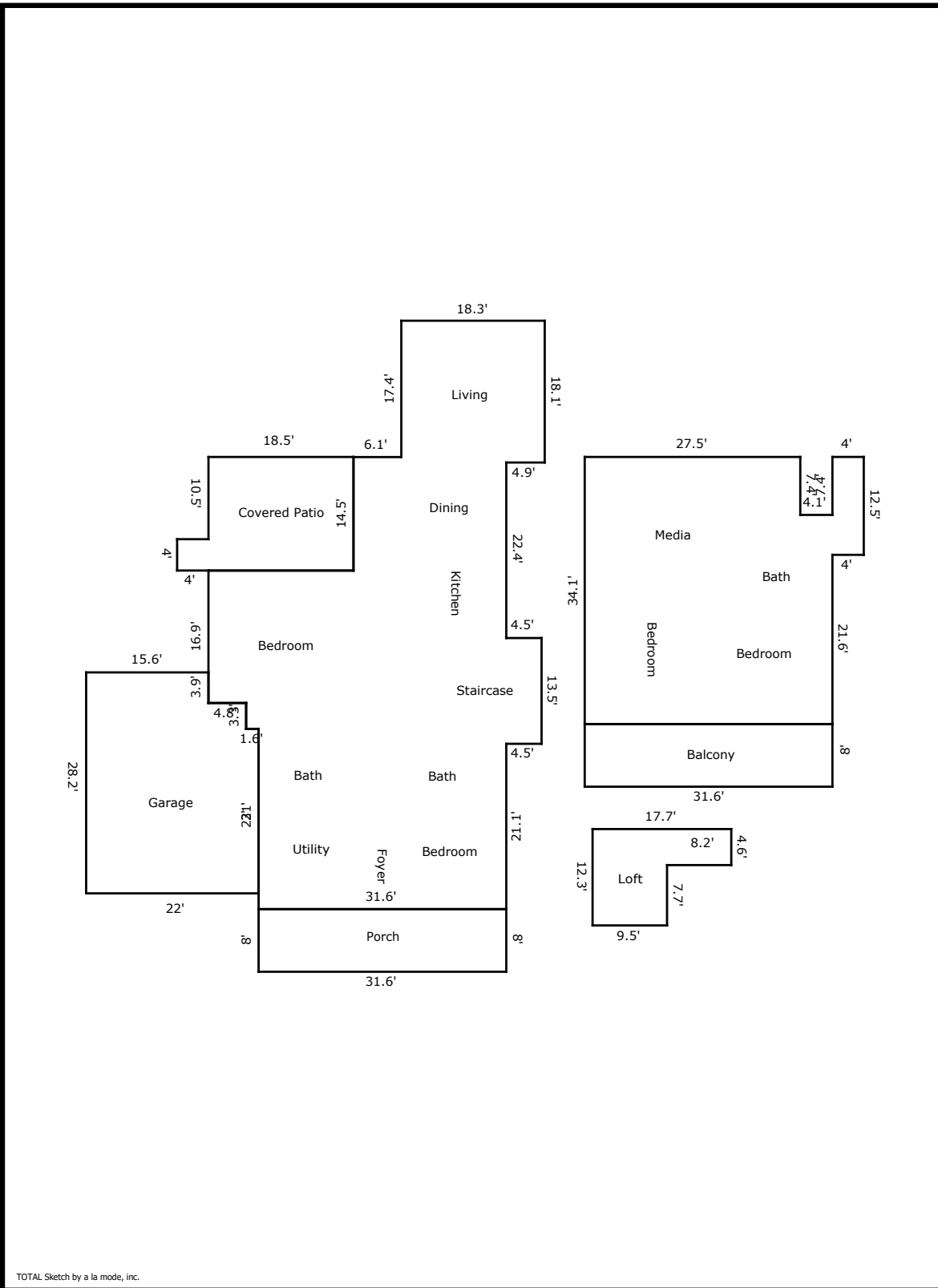

TOTAL Sketch by a la mode, inc.

Building Sketch (Page - 2)

Borrower	Jewell Jeff & Jewell Alice				
Property Address	1165 Turtle Trl				
City	New Braunfels	County	Comal	State	TX
				Zip Code	78130
Lender	Fairway Independent Mortgage Corporation				

TOTAL Sketch by a la mode, inc.

Area Calculations Summary

Living Area		Calculation Details
First Floor	2143.91 Sq ft	$13.5 \times 4.5 = 60.75$ $18.3 \times 17.4 = 318.42$ $16.9 \times 4.8 = 81.12$ $0.7 \times 4.9 = 3.43$ $19.5 \times 14.5 = 282.75$ $33.2 \times 20.2 = 670.64$ $23 \times 31.6 = 726.8$
Second Floor	1097.22 Sq ft	$12.5 \times 4 = 50$ $26.7 \times 4.1 = 109.47$ $34.1 \times 27.5 = 937.75$
Third Floor	154.57 Sq ft	$4.6 \times 8.2 = 37.72$ $12.3 \times 9.5 = 116.85$
Total Living Area (Rounded):	3396 Sq ft	
Non-living Area		
Concrete Patio	284.25 Sq ft	$4 \times 4 = 16$ $14.5 \times 18.5 = 268.25$
2 Car Attached	590.16 Sq ft	$22 \times 21 = 462$ $3.3 \times 4.8 = 15.84$ $7.2 \times 15.6 = 112.32$
Open Porch	252.8 Sq ft	$31.6 \times 8 = 252.8$
Concrete Patio	252.8 Sq ft	$31.6 \times 8 = 252.8$