

# ACREAGE FOR SALE



## 14200 W. DLD Road, Juniata

Situated in an excellent location, this meticulously kept rural homestead is on a quiet road with four acres, one mile from blacktop, and a short drive from the tri-cities. If you're looking for a mature landscape in the country, you don't want to miss out on this!



Adam D. Pavelka, J.D. Jeffrey D. Parr

### LISTING AGENTS:

**ADAM D. PAVELKA, J.D.**

C: 402.984.7744 | E: Adam@AgriAffiliates.com

**JEFFREY D. PARR**

C: 402.984.7410 | E: JeffParr@AgriAffiliates.com

*Kent Richter, Bryan Danburg, Bart Woodward, Mike Wilken*



See Full Online Listing

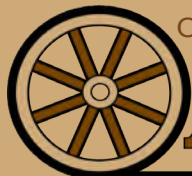

Offered exclusively by:

## AGRI AFFILIATES®

Hastings, NE • [AgriAffiliates.com](http://AgriAffiliates.com) • 402.519.2777

Information contained herein was obtained from sources deemed reliable. We have no reason to doubt the accuracy, but the information is not guaranteed. Prospective Buyers should verify all information. All maps provided by Agri Affiliates, Inc. are approximations only, to be used as a general guideline, and not intended as survey accurate. As with any agricultural land, this property may include noxious weeds. Agri Affiliates, Inc. and all agents are acting as Agent of the Seller.

## Property Information & Location

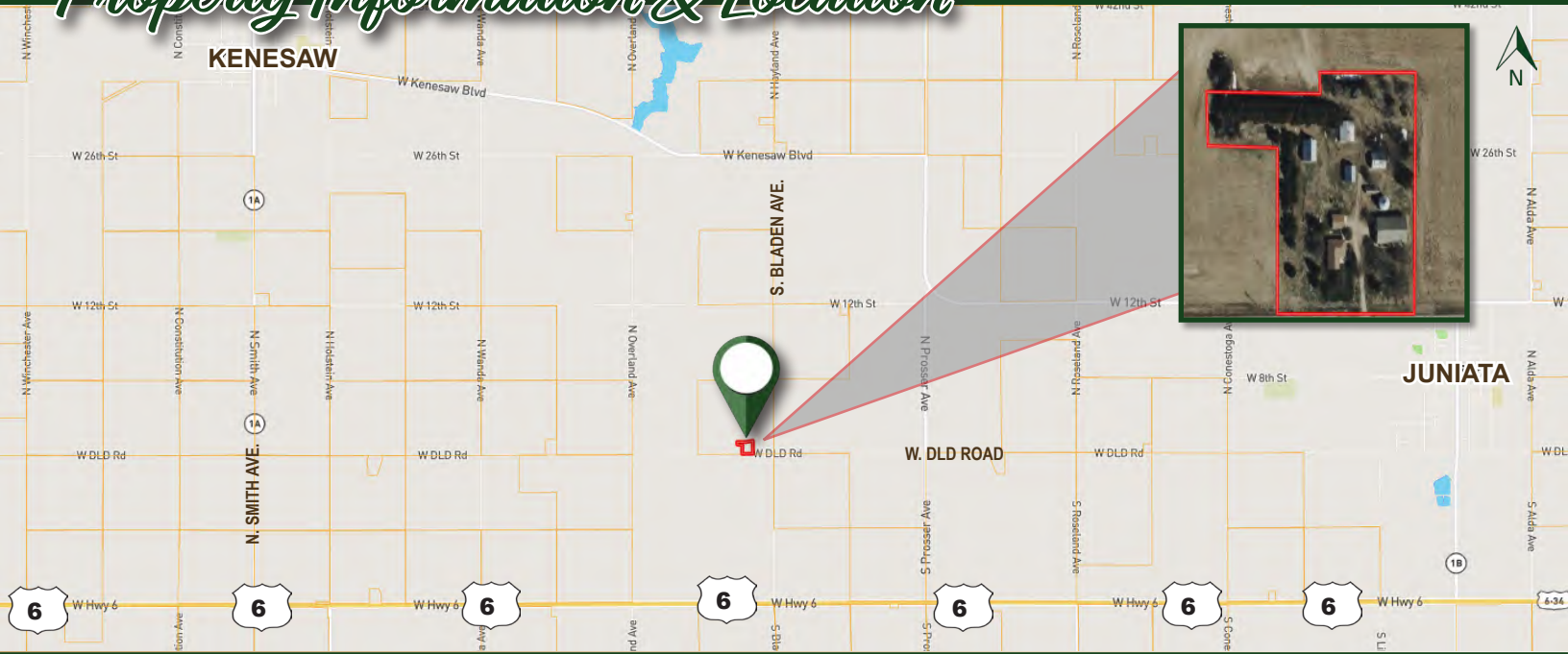

**LEGAL DESCRIPTION:**

4.00 ± acres located in the South Half of the Southeast Quarter (S½SE¼) of Section Seven (7), Township Seven (7) North, Range Eleven (11) West of the 6th P.M., Adams County, Nebraska. Also known as, 14200 W. DLD Road, Juniata, Nebraska.

**LOCATION:**

From Kenesaw, Nebraska: approximately 2 miles south on Smith Avenue, then 3.25 miles east on West DLD Road to the southwest corner of the property.

**ACRES & TAXES:**

Surveyed Acres | 4.00 ± acres  
 Estimated 2025 Real Estate Taxes | \$2,120.00

**PRICE:**

**\$449,000.00**



*Showing by appointment only.*



## Property Details

<b>LIVING SPACE:</b>	1,800 sq. ft.
<b>BASEMENT:</b>	1,176 sq. ft.
<b>BEDROOMS:</b>	4
<b>BATHROOMS:</b>	2
<b>GARAGE:</b>	Detached 2-car; 672 sq. ft.
<b>OUTBUILDINGS:</b>	<ul style="list-style-type: none"> <li>● Steel Morton Building - 3,600 sq. ft.</li> <li>● Grain Storage Bin</li> <li>● Barn - 512 sq. ft.</li> <li>● Utility Building - 1,296 sq. ft.</li> <li>● Utility Building - 672 sq. ft.</li> <li>● Utility Building - 1,008 sq. ft.</li> <li>● Poultry House - 384 sq. ft.</li> </ul>



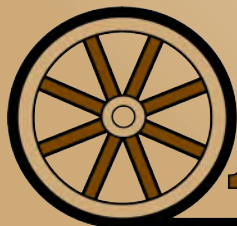

**AGRI AFFILIATES**®

Hastings, NE • [AgriAffiliates.com](http://AgriAffiliates.com) • 402.519.2777 • [f](#) [@](#) [X](#) [in](#) [v](#)