

Tax Year: 2026

Scale: 1:4615.61 Basemap: Cadastral Application Base Map

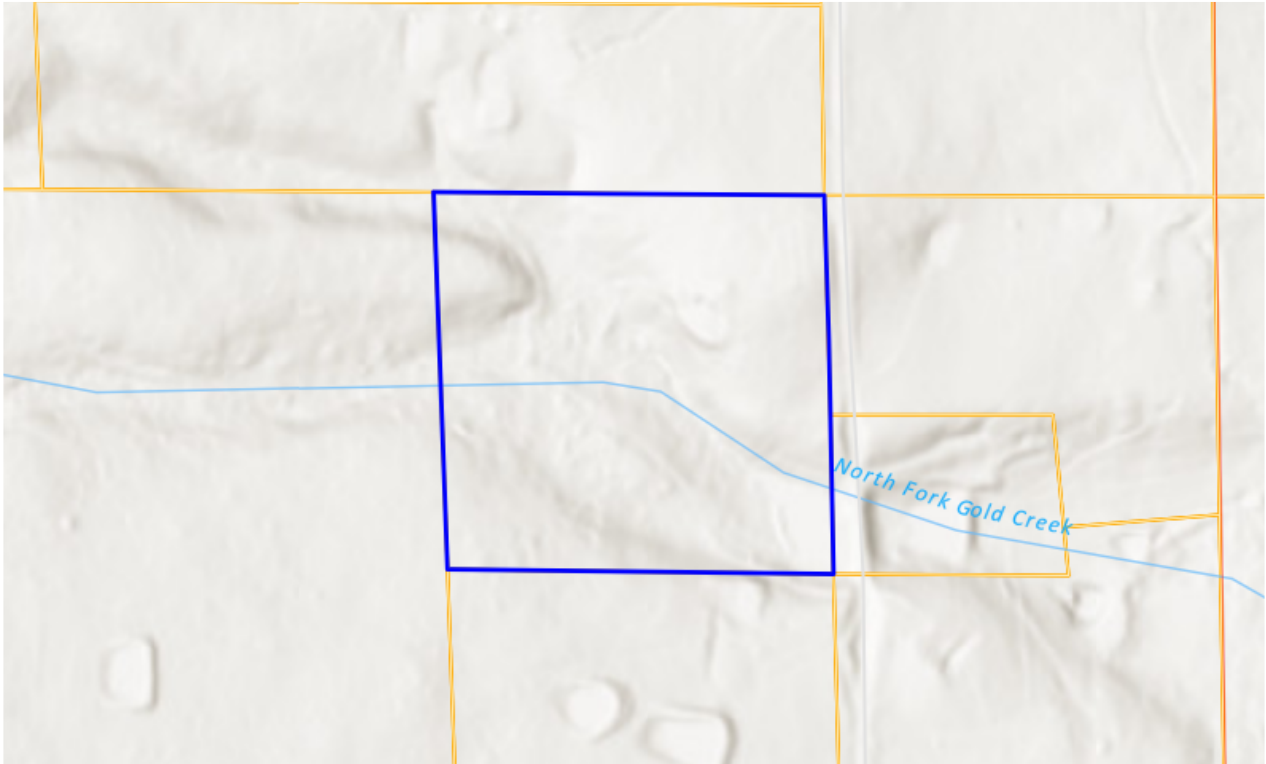

Summary

Primary Information

Property Category: RP

Subcategory: Residential Property

Geocode: 13-1366-22-1-01-12-0000

Assessment Code: 0001236100

Primary Owner:
MAPLES JAMES W & MICHELLE E AND
794 PHILLIPS RD
ARROYO GRANDE, CA 93420-5019
Note: See Owners section for all owners

Property Address:
390 N GOLD CREEK LOOP
HAMILTON, MT 59840

Certificate of Survey: n/a

Legal Description: S22, T05 N, R21 W, ACRES 10.25, NWNESE INDEX 18
CS#658266-R TRACT C

Last Modified: 1/28/2026 19:4:19 PM

Tax Year: 2026

General Property Information

Neighborhood: 213.829.0	Property Type: Improved Property
Living Units: 1	Levy District: 13-4739-9-5
Zoning: n/a	Ownership: 100
LinkedProperty: No linked properties exist for this property	
Exemptions: No exemptions exist for this property	
Condo Ownership:	
General: n/a	Limited: n/a

Property Factors

Topography: n/a	Fronting: n/a
Utilities: n/a	Parking Type: n/a
Access: n/a	Parking Quantity: n/a
Location: n/a	Parking Proximity: n/a

Land Summary

Land Type:	Acres:	Value:
Grazing	n/a	n/a
Fallow	n/a	n/a
Irrigated	n/a	n/a
Continuous Crop	n/a	n/a
Wild Hay	n/a	n/a
Farmsite	n/a	n/a
ROW	n/a	n/a
NonQual Land	n/a	n/a
Total Ag Land	n/a	n/a
Total Forest Land	n/a	n/a
Total Market Land	10.25	n/a

Deed Information

Deed Date	Book	Page	Recorded Date	Document Number	Document Type
12/22/2020	n/a	n/a	12/28/2020	753710	Warranty Deed
10/31/2019	n/a	n/a	11/4/2019	737004	Warranty Deed
4/15/2013	n/a	n/a	4/3/2014	676/673	Warranty Deed
4/15/2013	n/a	n/a	4/19/2013	666/477	Notice of Purchaser's Interest
12/15/2011	n/a	n/a	12/19/2011	649/587	Warranty Deed
10/31/2011	n/a	n/a	11/1/2011	648/248	Trustee's Deed (and Deed of Trust)
7/6/2006	574	045	N/A	n/a	n/a
7/6/2006	574	046	N/A	n/a	n/a

Owners

Tax Year: 2026

Party #1

Default Information:	MAPLES JAMES W & MICHELLE E AND 794 PHILLIPS RD ARROYO GRANDE, CA 93420-5019
Ownership %:	100
Primary Owner:	Yes
Interest Type:	Fee Simple
Last Modified:	7/10/2023 15:43:50 PM

Party #2

Default Information:	CONNER DONALD WAYNE AND 794 PHILLIPS RD ARROYO GRANDE, CA 93420-5019
Ownership %:	100
Primary Owner:	Yes
Interest Type:	Fee Simple
Last Modified:	7/10/2023 15:43:50 PM

Party #3

Default Information:	GEISSEL ZACHARY M 794 PHILLIPS RD ARROYO GRANDE, CA 93420-5019
Ownership %:	100
Primary Owner:	Yes
Interest Type:	Fee Simple
Last Modified:	7/10/2023 15:43:50 PM

Appraisals

Appraisal History

Tax Year	Land Value	Building Value	Total Value	Method
2025	360800	302000	662800	MKT
2024	181500	336600	518100	MKT
2023	181500	336600	518100	MKT

Market Land

Tax Year: 2026

Market Land Item #1

Method: Acre	Type: Category 5
Width: n/a	Depth: n/a
Square Feet: n/a	Acres: 10.25
Class Code: 2201	Value: n/a

Dwellings

Dwelling #1

Dwelling Information

Dwelling Type SFR	Style 08 - Conventional	Year Built 1972
Residential Type: SFR	Style: 08 - Conventional	Roof Material: 10 - Asphalt Shingle
Year Built: 1972	Roof Type: 3 - Gable	Attic Type: 0 - None
Effective Year: 2000	Exterior Walls: 1 - Frame	Exterior Wall Finish: 6 - Wood Siding or Sheathing
Story Height: 1.0	Degree Remodeled: n/a	
Grade: 5		
Class Code: 3501		
Year Remodeled: n/a		

Mobile Home Details

Manufacturer: n/a	Serial #: n/a
Width: n/a	Length: n/a
Model: n/a	

Basement Information

Foundation: 2 - Concrete	Finished Area: 1390
Daylight: Y	Basement Type: 3 - Full
Quality: 3 - Typical	

Heating/Cooling Information

Type: Non-Central	System Type: 1 - Floor/Wall/Space
Fuel Type: 3 - Gas	Heated Area: 2950

Living Accomodations

Bedrooms: 4	Family Rooms: n/a
Full Baths: 3	Half Baths: n/a

Addl Fixtures: 5

Additional Information

Tax Year: 2026

Fire Places
 Stories: n/a
 Openings: n/a

Stacks: n/a
 Prefab/Stove: n/a

Garage Capacity: n/a

Cost & Design: n/a

Flat Add: n/a

% Complete: n/a

Description: n/a

Dwelling Ammenities

View: n/a

Access: n/a

Area Used in Cost

Basement: 1852

Addl Floors: n/a

First Floor: 1560

Second Floor: n/a

Half Story: n/a

Unfinished Area: n/a

Attic: n/a

SFLA: 1560

Depreciation Information

CDU: n/a

Physical Condition: Good (8)

Desirability
 Property: Good (8)

Location: Good (8)

Depreciation Calculation

Age: 24

Pct Good: 0.75

RCNLD: n/a

Additions / Other Features

Lower Addtns	First	Second	Third	Area	Year	Cost
n/a	33 - Deck, Wood	n/a	n/a	104	n/a	n/a
n/a	11 - Porch, Frame, Open	n/a	n/a	20	n/a	n/a
n/a	11 - Porch, Frame, Open	n/a	n/a	20	n/a	n/a
n/a	14 - Porch, Frame, Enclosed	n/a	n/a	180	n/a	n/a
n/a	33 - Deck, Wood	n/a	n/a	153	n/a	n/a
n/a	33 - Deck, Wood	n/a	n/a	178	n/a	n/a

No additional features exist for this property

Other Buildings

Tax Year: 2026

Outbuilding/Yard Improvement #1

Type: Residential	Description: AAL1 - Lean-to, 1 story, pole frame
Quantity: 1	Year Built: 2015
Grade: L	Condition: Res Average
Functional: n/a	Class Code: 3501

Dimensions

Width/Diameter: 6	Length: 24
Size/Area: 144	Height: n/a
Bushels: n/a	Circumference: n/a

Outbuilding/Yard Improvement #2

Type: Residential	Description: RRS1 - Shed, Frame
Quantity: 1	Year Built: 1940
Grade: C	Condition: Res Poor
Functional: n/a	Class Code: 3501

Dimensions

Width/Diameter: 4	Length: 8
Size/Area: 32	Height: n/a
Bushels: n/a	Circumference: n/a

Outbuilding/Yard Improvement #3

Type: Residential	Description: RRS1 - Shed, Frame
Quantity: 1	Year Built: 1940
Grade: C	Condition: Res Poor
Functional: n/a	Class Code: 3501

Dimensions

Width/Diameter: 10	Length: 12
Size/Area: 120	Height: n/a
Bushels: n/a	Circumference: n/a

Outbuilding/Yard Improvement #4

Type: Residential	Description: RRS1 - Shed, Frame
Quantity: 1	Year Built: 2014
Grade: L	Condition: Res Fair
Functional: n/a	Class Code: 3501

Dimensions

Width/Diameter: 8	Length: 20
Size/Area: 160	Height: n/a
Bushels: n/a	Circumference: n/a

Tax Year: 2026

Outbuilding/Yard Improvement #5

Type: Residential	Description: RRS1 - Shed, Frame
Quantity: 1	Year Built: 2015
Grade: A	Condition: Res Fair
Functional: n/a	Class Code: 3501

Dimensions

Width/Diameter: 18	Length: 24
Size/Area: 432	Height: n/a
Bushels: n/a	Circumference: n/a

Outbuilding/Yard Improvement #6

Type: Residential	Description: RRT7 - Deck, covered patio
Quantity: 1	Year Built: 2015
Grade: L	Condition: Res Average
Functional: n/a	Class Code: 3501

Dimensions

Width/Diameter: 4	Length: 12
Size/Area: 48	Height: n/a
Bushels: n/a	Circumference: n/a

Commercial

No commercial buildings exist for this parcel

Ag/Forest Land

No ag/forest land exists for this parcel

Conservation Easements

No conservation easements exist for this parcel

Tax Year: 2026

Disclaimer

The Montana State Library (MSL) provides this product/service for informational purposes only. MSL did not produce it for, nor is it suitable for legal, engineering, or surveying purposes. Data from disparate sources may not be in vertical alignment. Consumers of this information should review or consult the primary data and information sources to ascertain the viability of the information for their purposes. The MSL provides these data in good faith and in no event, shall be liable for any incorrect results or analysis, any lost profits and special, indirect or consequential damages to any party, arising out of or in connection with the use or the inability to use the data or the services provided. The MSL makes these data and services available as a convenience to the public, and for no other purpose. The MSL reserves the right to change or revise published data and/or services at any time.