

Soils Map

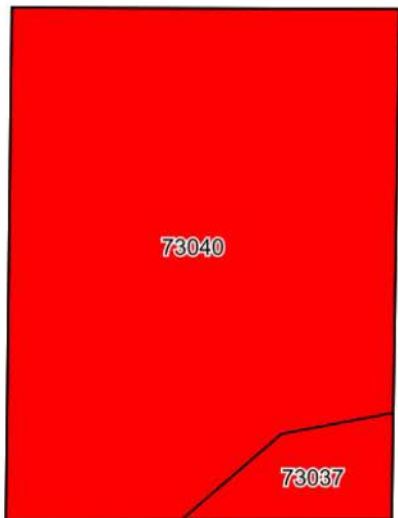

©2026 AgriData, Inc.

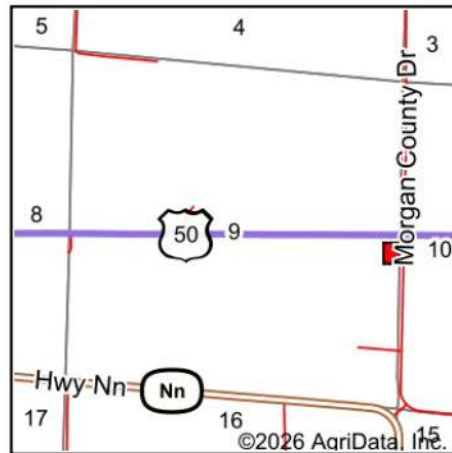

State: **Missouri**
 County: **Morgan**
 Location: **9-45N-19W**
 Township: **Richland**
 Acres: **2**
 Date: **3/5/2026**

BigIron
 REALTY

Maps Provided By:



© AgriData, Inc. 2025

www.AgriDataInc.com



Soils data provided by USDA and NRCS.

Area Symbol: MO141, Soil Area Version: 29

Code	Soil Description	Acres	Percent of field	Non-Irr Class Legend	Non-Irr Class *c	Corn Bu	Winter wheat Bu	*n NCCPI Soybeans
73040	Maplewood silt loam, 2 to 5 percent slopes, eroded	1.85	92.5%		Ile	2	1	45
73037	Friendly silt loam, 1 to 3 percent slopes	0.15	7.5%		Ile			44
Weighted Average					2.00	1.8	0.9	*n 44.9

*n: The aggregation method is "Weighted Average using all components"

*c: Using Capabilities Class Dominant Condition Aggregation Method