

Soils Map

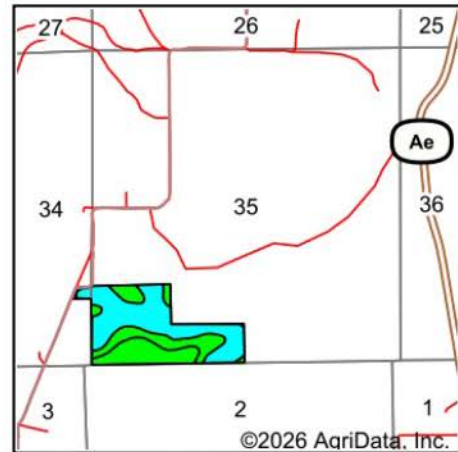
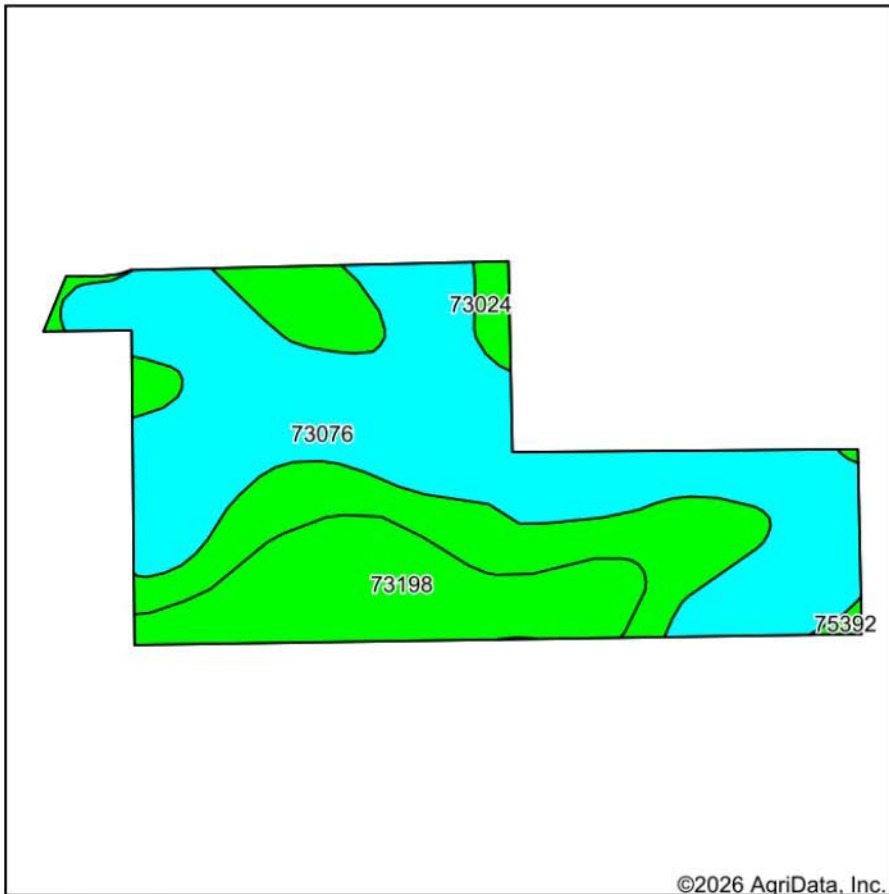

State: **Missouri**
 County: **Texas**
 Location: **35-32N-12W**
 Township: **Upton**
 Acres: **62**
 Date: **4/24/2026**

BigIron
 REALTY

Maps Provided By:



Soils data provided by USDA and NRCS.

Area Symbol: MO215, Soil Area Version: 29

Code	Soil Description	Acres	Percent of field	Non-Irr Class Legend	Non-Irr Class *c	Winter wheat Bu	*n NCCPI Soybeans
73076	Mano-Ocie complex, 15 to 35 percent slopes, stony	33.49	54.0%		Vle		6
73024	Mano-Ocie complex, 8 to 15 percent slopes, stony	15.92	25.7%		IVe		38
73198	Gressy-Viraton complex, 3 to 8 percent slopes	12.29	19.8%		IIIe		46
75392	Stultz very cobbly loam, 1 to 3 percent slopes, frequently flooded	0.30	0.5%		IIIw	3	37
Weighted Average					4.88	*	*n 22.3

*n: The aggregation method is "Weighted Average using all components"

*c: Using Capabilities Class Dominant Condition Aggregation Method